

## Highways Committee

24 July 2009



### **Proposed Traffic Regulation Order at Seascape Primary School, Ellison Road, Peterlee**

---

#### **Report of Terry Collins, Corporate Director, Neighbourhood Services**

---

##### **1.0 Purpose of the Report**

- 1.1 To advise Members of objections to the The County Council of Durham (Primary and Nursery School, Ellison Road, Peterlee) (Prohibition of Waiting/Prohibition of Stopping on School Entrance Markings) Order 2009.

##### **2.0 Background**

- 2.1 The development of the new Seascape Primary School included various highway works such as:
- the widening of Eden Lane to 6 metres between the vehicular access to the school and its junction with Ellison Road;
  - widening to 6 metres the vehicular access road to the school;
  - additional footpaths and dropped kerbs;
  - a Traffic Regulation Order (TRO) on some of the streets surrounding the new school, to prohibit waiting and stopping on school entrance markings between 8.00am and 6.00pm Monday to Saturday inclusive;
  - a Park and Stride scheme based on the use of the Peterlee Sports and Social Club car park just to the south of the new school.
- 2.2 The aim of the order is to provide safer access routes to the school by deterring indiscriminate parking of vehicles on these routes around the new school, especially at the pedestrian and vehicle entrances to the school which is all in line with the School Travel Plan (STP). The STP also sought to encourage as many parents as possible to use the 'Park & Stride' car park in order to minimise the number of vehicles parking on street and causing potential conflict with residents parking requirements. The Head Teacher at the school received permission from the Secretary of the Club to use their car park as a 'Park & Stride' zone. The TRO will also assist the safer passage of residents' vehicles along the roads around the school by regulating where vehicles can park at school opening and closing times.
- 2.3 An Initial Consultation was carried out in November 2008 with the usual statutory consultees, other organisations which may be affected by the order and 35 properties abutting or close to the proposed TRO restrictions. Each consultee received a letter, a plan of the proposals and a pre-paid reply card and was invited to return their comments.

- 2.4 A total of 21 responses were received by 8 January 2009 of which 8 (38%) were in favour, 6 (29%) gave conditional support, 4 (19%) were not in favour and 3 (14%) did not give a view.
- 2.5 The TRO was formally advertised in March 2009. Notices were also posted on site between 6 May and 1 June 2009. Three letters of objection have been received to the proposed TRO.
- 2.6 The Chief Constable fully supports the proposals which will hopefully go some way to alleviating the road safety concerns at this location which poor parking creates.
- 2.7 As mentioned earlier the Club had given its agreement to the use of its car park for the Park & Stride scheme. Unfortunately this agreement was subsequently withdrawn and in the absence of other appropriate off street parking areas the Park & Stride scheme is no longer possible.
- 2.8 The Local Members, Councillors Audrey Laing and Gordon Tennant have been consulted and support the proposals.

### **3.0 Current position**

- 3.1 Representation 1 (to published TRO)

**Inconvenience from traffic and inconsiderate parking at school opening / closing times which will be made worse by proposed waiting restrictions.**

*Response:*

*The objection was made at a time when the widening of Eden Lane had not been completed and hence the benefits of the road widening were not being experienced by residents, drivers travelling to the school and other users of Eden Lane. The proposed traffic regulation measures will regulate parking on Eden Lane and Ellison Road in the vicinity of the school and will regulate parking at school opening/closing time.*

- 3.2 Representation 2 (to published TRO)

**Inadequate dropping off facilities at school, creating parking problems for local residents and problems between adjoining neighbours.**

*Response:*

*The new school project did include a proposal for a Park & Stride car park. As mentioned previously agreement was reached with the land owner but this was subsequently withdrawn. In the absence of any other appropriate off street parking areas the Park & Stride scheme is no longer possible. The Town Council objected on the grounds that local residents cannot park outside their own residence between the hours of 8.00am and 6.00pm on Monday to Saturday. The proposed waiting restrictions are considered to be the minimum that are required to discourage indiscriminate parking at school opening/closing times and for any out of hours use of the school*

*premises. However regarding the days of operation further consideration suggests that school use will not be substantial on the Saturday and that this could be removed from the proposed restrictions.*

3.3 Representation 3 (to published TRO)

**Proposals will create parking problems for local resident, road not wide enough for all the traffic, harden some of grassed area to provide parking areas right outside homes.**

*Response:*

*The objection was made at a time when the widening of Eden Lane had not been completed and hence the benefits of the road widening were not being experienced by residents, drivers travelling to the school and other users of Eden Lane. The proposed waiting restrictions finish some considerable distance from the respondent's property (100 m) and any displaced parking is unlikely to extend this far along Eden Lane. The request for verge hardening is a long standing one and stems from a desire to have vehicles parked right outside the respondent's home to avoid damage to their vehicle and to avoid the need to cross the grassed areas with bins and shopping.*

3.4 Representation 4 (to Initial Consultation)

**Proposals will prevent the use of the areas of hardened verge which were provided to allow residents to park off the highway.**

*Response:*

*Whilst providing a place for vehicles to park off the carriageway the hardened verge was introduced to remove the grassed area between the carriageway and the footway which was constantly in a very poor condition due to parked vehicles. The proposed waiting restrictions are considered to be the minimum that are required to discourage indiscriminate parking at school opening/closing times and for any out of hours use of the school premises. However regarding the days of operation further consideration suggests that school use will not be substantial on the Saturday and that this could be removed from the proposed restrictions.*

3.5 Representations 5 and 6 (to Initial Consultation)

**Proposals will create parking problems for local resident.**

*Response:*

*See Representation 3.4 above.*

3.6 Representation 7 (to Initial Consultation)

**Will just move the problem up/down the street.**

*Response:*

*The proposed waiting restrictions are considered to be the minimum that are required to discourage indiscriminate parking at school opening/closing times and for any out of hours use of the school premises. However regarding the days of operation further consideration suggests that school use will not be substantial on the Saturday and that this could be removed from the proposed restrictions.*

3.7 The Chief Constable has advised that he would support the removal of the proposed restrictions on a Saturday.

**4.0 Recommendation and Reasons**

4.1 It is recommended that Members set aside the representations and agree to the introduction of the traffic regulation order amended as follows:

Prohibition of Waiting Monday to Friday between the hours of 8.00am and 6.00pm; and  
Prohibition of Stopping on School Entrance markings Monday to Friday 8.00am to 6.00pm.

**Background Papers**

Correspondence in office file.

---

**Contact: John Ray Tel: 0191 332 4429**

---

---

## **Appendix 1: Implications**

---

### **Finance**

All the costs of processing and implementing the TRO are being provided from the Durham County Schools for the Future (DCSF's) New Deals for Schools – Modernisation programme.

### **Staffing**

None

### **Equality and Diversity**

None

### **Accommodation**

None

### **Crime and Disorder**

None

### **Sustainability**

None

### **Human Rights**

None

### **Localities and Rurality**

As detailed in the report.

### **Young People**

Safer for children, parents and residents.

### **Consultation**

Consultation on the TRO has been carried out.

### **Health**

Safer for children, parents and residents.

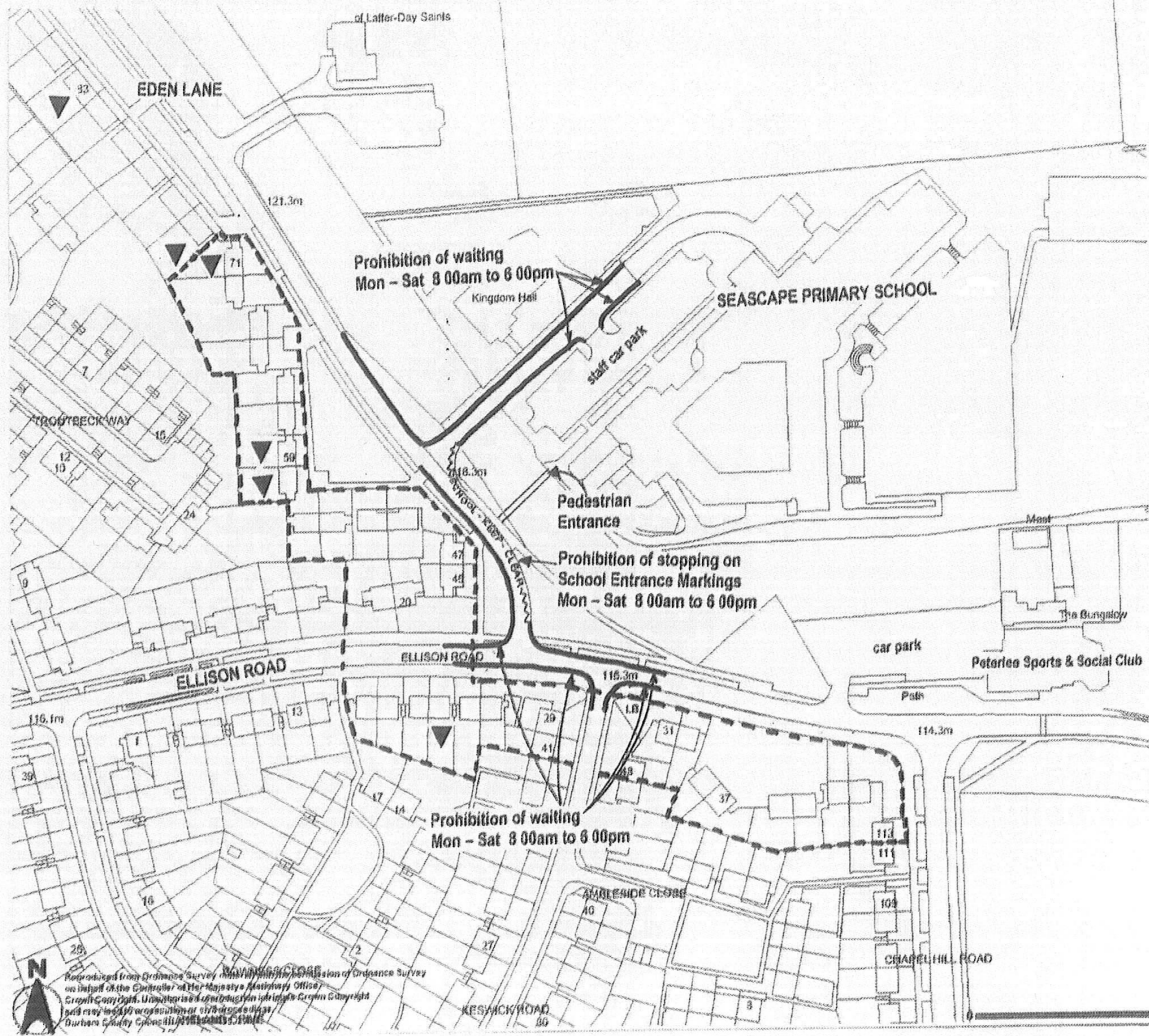

Reproduced from Ordnance Survey material with the permission of Ordnance Survey on behalf of the Controller of Her Majesty's Stationary Office © Crown copyright. Unauthorised reproduction infringes Crown copyright and may lead to prosecution or civil proceedings. Durham County Council. LA 100019779 2009.

- ◻ Residential Properties Consulted
- ▼ Respondents who opposed the Traffic Regulation Order

Reproduced from Ordnance Survey material with the permission of Ordnance Survey on behalf of the Controller of Her Majesty's Stationary Office © Crown copyright. Unauthorised reproduction infringes Crown copyright and may lead to prosecution or civil proceedings. Durham County Council. LA 100019779 2009.

| Rev/ Amdt | Drawn By |      | Approved By |      |      | Description Of Amendments |
|-----------|----------|------|-------------|------|------|---------------------------|
|           | Name     | Date | Name        | Date | Sign |                           |
|           |          |      |             |      |      |                           |
|           |          |      |             |      |      |                           |
|           |          |      |             |      |      |                           |
|           |          |      |             |      |      |                           |

**Durham**  
County Council

**STRATEGIC HIGHWAYS MANAGEMENT**

CORPORATE DIRECTOR OF NEIGHBOURHOOD SERVICES

COUNTY HALL, DURHAM, DH1 1TA

Project **SEASCAPE PRIMARY SCHOOL ELLISON ROAD, PETERLEE**

Drawing **Location Plan: Respondents**

Scales **NTS**

Project/Drawing No. \_\_\_\_\_

Rev. 0/-