

PUBLIC PATH (STOPPING UP) (DIVERSION) ORDER

TOWN AND COUNTRY PLANNING ACT 1990 SECTION 257

FORMER HAWTHORN COLLIERY MURTON BRIDLEWAY NO 29 STOPPING UP AND DIVERSION ORDER

This Order is made by Easington District Council under Section 257 of the Town and Country Planning Act 1990 because it is satisfied that it is necessary to stop up and divert the bridleway to which this Order relates in order to enable development to be carried out in accordance with planning permission granted under Part III of the Town and Country Planning Act 1990 namely industrial development comprising B1 Business Use B2 General Industrial Use and B8 Storage and Distribution.

This Order is also made under Section 53A(2) of the Wildlife and Countryside Act 1981 ("The 1981 Act") because it appears to the Authority that the Durham County Council definitive map and statement require modification in consequence of the occurrence of an event specified in Section 53(3)(a)(i) of the 1981 Act, namely, the stopping up and diversion (as authorised by this Order) of the highway hitherto shown or required to be shown in the map and statement.

BY THIS ORDER:

1. The bridleway over the land shown by a solid black line on the attached map and described in Part 1 of the Schedule to this order ("the Schedule") shall be stopped up as provided below and the Durham County Council definitive map and statement shall be modified accordingly.
2. There shall be created to the reasonable satisfaction of Easington District Council an alternative highway for use as a replacement for the said footpath as provided in Part 2 of the Schedule and shown by bold black dashes on the attached map.
3. The stopping up and diversion of the footpath shall have effect on the date on which Easington District Council certify that the terms of Article 2 have been complied with and upon the occurrence of that diversion the Durham County Council definitive map and statement shall be modified accordingly.
4. The cost of carrying out the works will be paid by Easington District Council.

SCHEDULE

PART 1

The whole width of the bridleway from point A to point B for a length of 660 metres as shown with a solid black line on the attached map.

PART 2

Description of site of alternative highway

A length of bridleway of 123 metres with a width of 3.0 metres running from point A to point C and continuing with a further length of 259 metres at a width of 3.0 metres between point C and point D and a further length of 485 metres at a width of 3.0

metres between point D and point B as shown by bold black dashes on the attached map.

THE COMMON SEAL of the
DISTRICT COUNCIL OF EASINGTON
was hereunto affixed and delivered
on the date hereof in the presence
of:-

Chairman

R Taylor

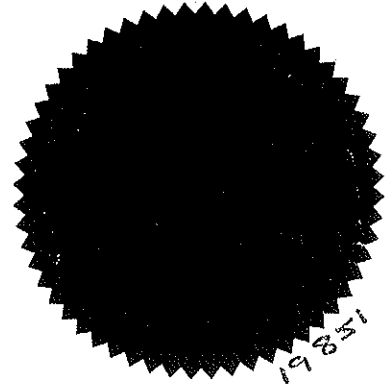

Authorised Proper Officer

Johnson

This Order was made by the Council of the District of Easington on the *2nd* day
of *October*, 2008

THE COMMON SEAL of the
DISTRICT COUNCIL OF EASINGTON
was hereunto affixed and delivered
on the date hereof in the presence
of:-

Chairman

Authorised Proper Officer

This Order was confirmed by the Council of the District of Easington on the _____ day
of _____ 2008

DT/PH MO/080802
21.08.08

NOTES

THIS DRAWING WAS PRODUCED ON COMPUTER. ANY MANUAL AMENDMENTS MUST ALSO BE CARRIED OUT ON THE COMPUTER DWG. FIGURED DIMENSIONS MUST BE TAKEN NOT SCALED MEASUREMENTS. ALL DISCREPANCIES IN THIS DRAWING MUST BE REPORTED TO THE SUPERVISING OFFICER IMMEDIATELY. CONTRACTOR MUST CHECK ALL DIMENSIONS ON SITE.

Coordinates:

Point A: NZ3963.4599
 Point B: NZ3905.4567
 Point C: NZ3971.4589
 Point D: NZ3948.4578

REVISIONS

REVISION LETTER	DESCRIPTION	SEARCHED	INDEXED	DATE



District of **easington.**

PROJECT TITLE

Hawthorn Coke Works
 Proposed Bridleway diversion
 Bridleway No 29

DRAWING TITLE

General Layout

SCALE(S)

1:2500

DRAWN BY

B Weatherall

DATE

August 2008

CHECKED BY

REVISION

1

Weatherall

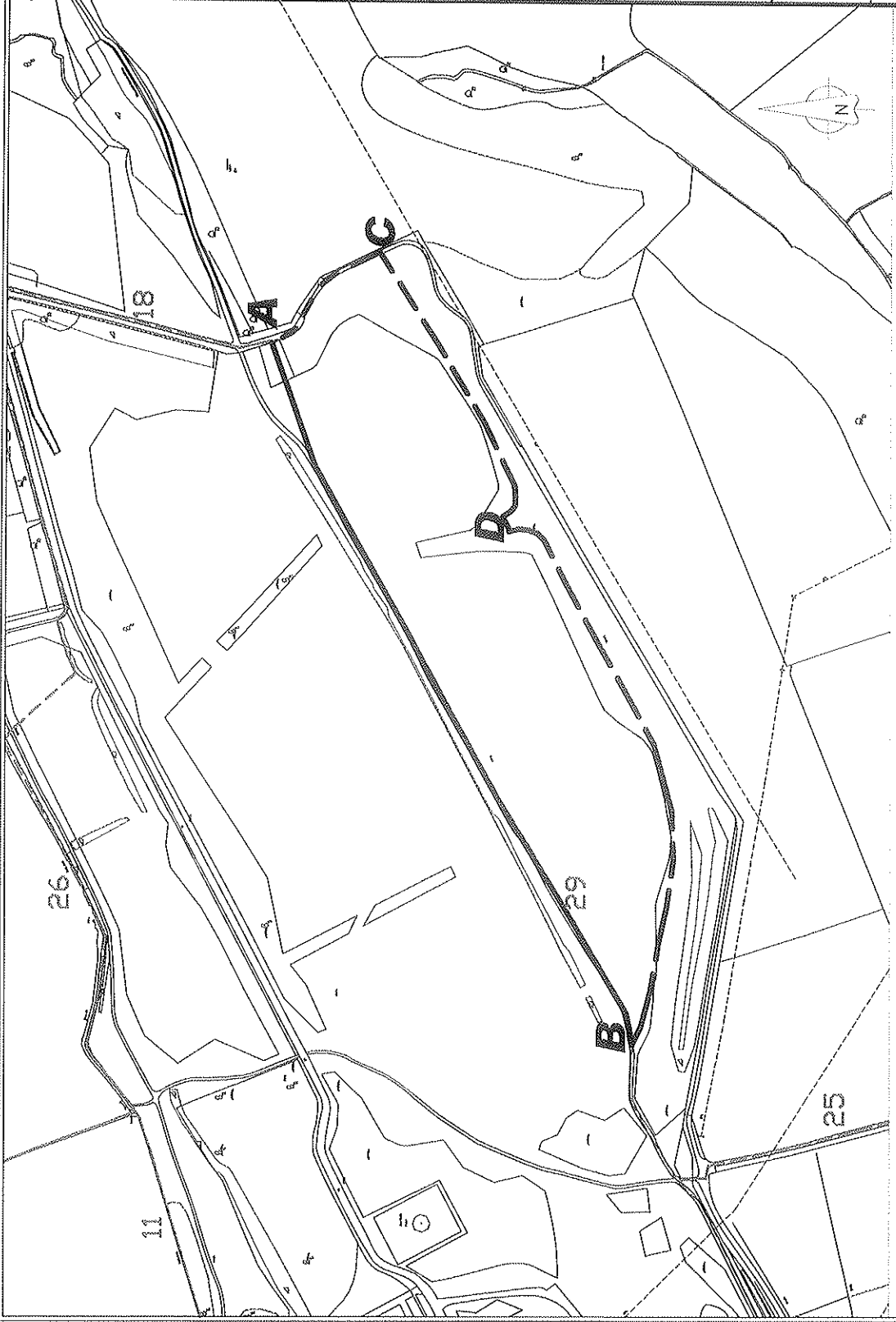

Description:
 Public bridleway to be extinguished the whole width from point A as shown by a solid line for a length of 660m and a width of 3.0m. Public bridleway to be created from point A to point C with a length of 123m and a width of 30m, continuing to point D with a length of 259m and a width of 3.0m, continuing to point B with a length of 485m and a width of 3.0m shown by a dashed line.