

## **Delegated Decision**

**12 October 2021**

**Temporary Traffic Regulation Order**

**Ordinary Decision/Key Decision No.**



---

## **Report of NEIGHBOURHOODS & CLIMATE CHANGE**

**Paul Watson – Interim Strategic Highways Manager, Technical Services**

### **Electoral division(s) affected:**

Stanley: Cllr C Marshall, Cllr A Hanson

### **Purpose of the Report**

To consider a request for temporary traffic regulation by Order on 29/11/21 for the purpose of water main renewal works on rear Slaidburn Road, Stanley.

### **Recommendation**

It is recommended that the Council exercises its powers under the Road Traffic Regulation Act 1984 to effect a Temporary Traffic Regulation Order to facilitate the proposed works

### **Background**

Works are proposed by NWL to undertake water main renewal works within the confines of the highway.

### **Options**

Other traffic management arrangements have been considered and the most appropriate method is for temporary road closure over a period of 5 days.

### **Recommendation**

The recommendation is approved and that following, consultations with the Chief of Police, arrangements be made to progress the advertising of Public Notices and sealing of an Order.

---

**Contact:** Steven Galloway

Tel: 03000 267095

---

---

## **Appendix 1: Implications**

---

### **Legal Implications**

TTRO checked, prepared and advertised via Legal Services

### **Finance**

Costs to be charged to the scheme/applicant.

### **Consultation**

Chief of Police, Local Members, Public Transport Providers (via the Public Transport Team)

### **Equality and Diversity / Public Sector Equality Duty**

N/A

### **Human Rights**

No impact

### **Crime and Disorder**

N/A

### **Climate Change**

N/A

### **Staffing**

Network Management Team

### **Accommodation**

N/A

### **Risk**

N/A

### **Procurement**

Advertising in a public newspaper with costs recharged to the scheme/applicant

Issue	Date
1	30/09/21
Drawn By	DF

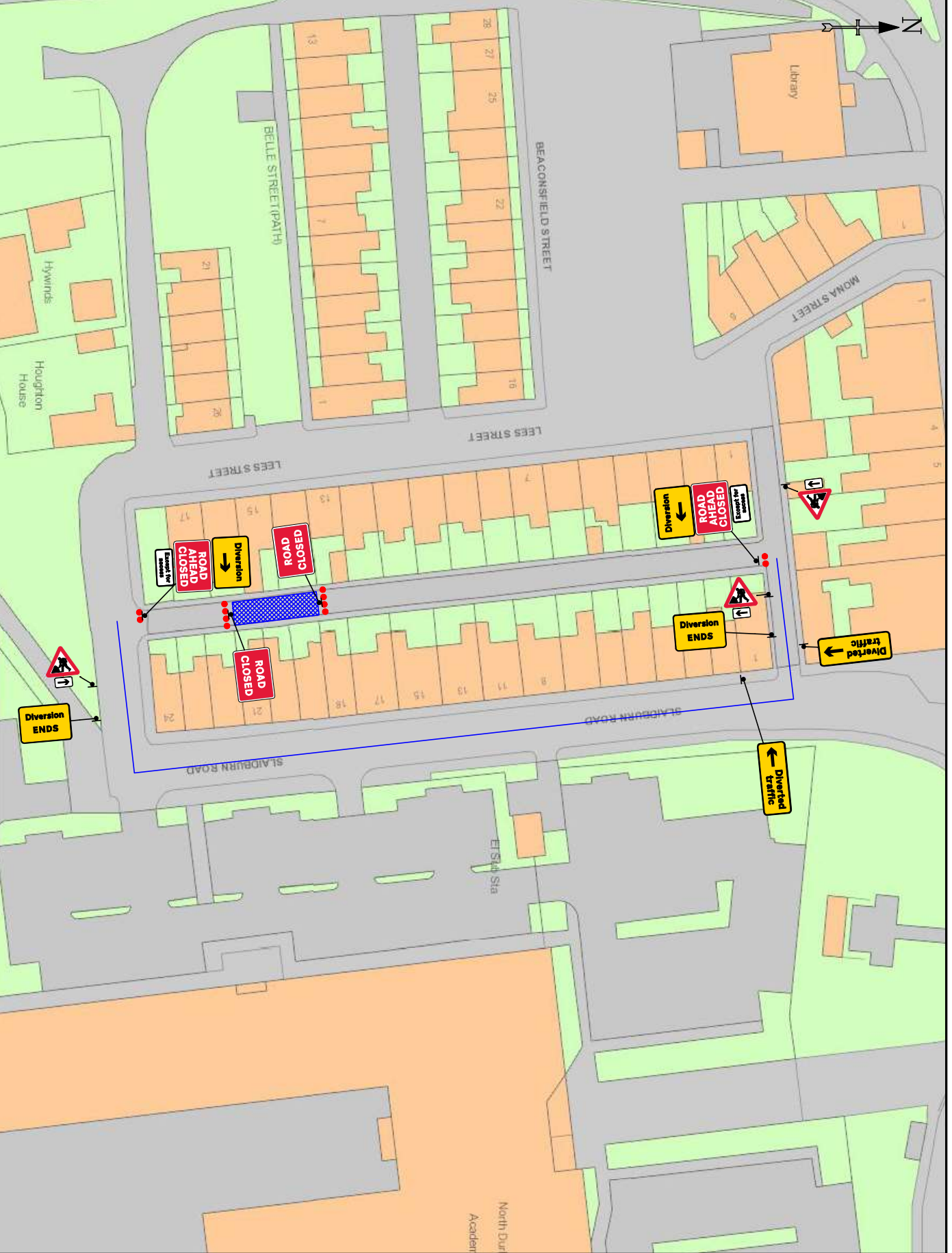

**DETAIL B** (Ⓟ)

- Single dual carriageway, urban or less - 450mm traffic cones, spacing 1.5m, staggered 0.75m.
- Dual carriageway national speed limit - 750mm traffic cones, spacing 1.5m, staggered 0.75m.

**DETAIL D** (Ⓟ)

- Single dual carriageway, urban or less - 450mm traffic cones, staggered 0.75m.
- Dual carriageway national speed limit - 750mm traffic cones, spacing 1.5m, staggered 0.75m.

**Notes**

- 1) All signs, warning lights, etc. to BS EN 12899-2008 should be provided in accordance with Table A.3.3 Appendix 11.
- 2) 45° tapering cones have 1.5m spacing, no oblateness.
- 3) 45° tapering cones have 1.5m spacing, no oblateness. The cones will be required for both standard and education works for lead signs and the facing wall of the changeover.

**SAFETY ZONE DIMENSIONS** (Ⓟ)

- Permanent speed limit 30mph or less
- Sideways safety zone 0.5m
- Longways safety zone 0.5m
- (Dimensions are minima)

**Specials** -

Standard Working Traffic Inclosure	Approved Cross and Light Vehicles
Two-way working	5.5m minimum
6.0m minimum	5.5m minimum
3.25x3.0m medium duty vehicle	5.5m minimum
3.0m medium duty vehicle	5.5m minimum

**Notes** -

**KEY**

- Ⓟ Traffic sign
- Traffic cone
- ← Traffic signals to Diagram 3000.1
- ▨ Working Space
- ▬ Pedestrian Barrier