

## **Delegated Decision**

**04<sup>th</sup> January 2021**

**Temporary Traffic Regulation Order**

**Ordinary Decision/Key Decision No.**



---

## **Report of NEIGHBOURHOODS & CLIMATE CHANGE**

**Paul Watson – Interim Strategic Highways Manager, Technical Services**

### **Electoral division(s) affected:**

Consett South, Cllr D Haney

### **Purpose of the Report**

To consider a request for temporary traffic regulation by Order on 21<sup>st</sup> March 2022 for the purpose of sewer repair works on The Bye, Consett.

### **Recommendation**

It is recommended that the Council exercises its powers under the Road Traffic Regulation Act 1984 to effect a Temporary Traffic Regulation Order to facilitate the proposed works

### **Background**

Works are proposed by NWL to undertake sewer repair works within the confines of the highway.

### **Options**

Other traffic management arrangements have been considered and the most appropriate method is for temporary between the hours of

### **Recommendation**

The recommendation is approved and that following, consultations with the Chief of Police, arrangements be made to progress the advertising of Public Notices and sealing of an Order.

---

**Contact:** Heather Freemantle

Tel: 03000 267095

---

---

## **Appendix 1: Implications**

---

### **Legal Implications**

TTRO checked, prepared and advertised via Legal Services

### **Finance**

Costs to be charged to the scheme/applicant.

### **Consultation**

Chief of Police, Local Members, Public Transport Providers (via the Public Transport Team)

### **Equality and Diversity / Public Sector Equality Duty**

N/A

### **Human Rights**

No impact

### **Crime and Disorder**

N/A

### **Climate Change**

N/A

### **Staffing**

Network Management Team

### **Accommodation**

N/A

### **Risk**

N/A

### **Procurement**

Advertising in a public newspaper with costs recharged to the scheme/applicant

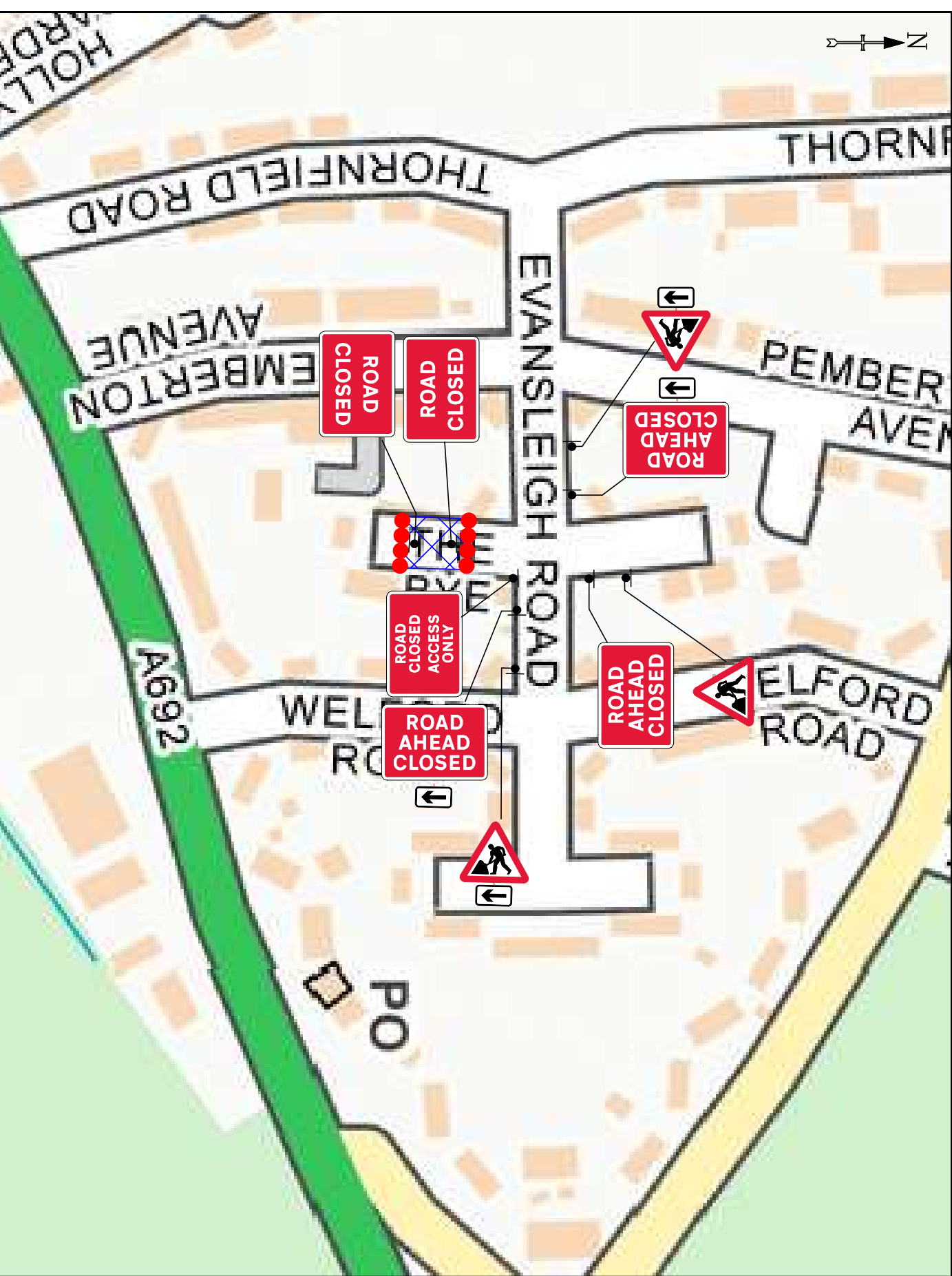
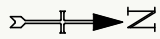

TEMPORARY  
TRAFFIC MANAGEMENT  
30 MPH

Issue	Date
1	13/12/21
Drawn By	JC

ROAD CLOSURE  
THE BYE, CONSETT  
DH8 8AJ

DETAIL B

Single carriageway 500m or less - 450mm traffic cones, spacing 1.5m.  
Dual carriageway 500m or less - 750mm traffic cones, spacing 1.5m.  
Dual carriageway national speed limit - 750mm traffic cones, spacing 1.5m.  
National speed limit - 1.5m.

Notes:  
1) During darkness, warning lights to BS EN 12369:2006 should be provided in accordance with Table A1.3 (Appendix 1).  
2) If cones have 1.5m spacing, no additional cones are required.  
3) If cones have 0.75m spacing, additional cones are required.  
4) Cones will be required for both standard and relaxation works for road repairs and the laying of new drains.

DETAIL D

Single carriageway 500m or less - 450mm traffic cones, spacing 1.5m.  
Dual carriageway 500m or less - 750mm traffic cones, spacing 1.5m.  
Dual carriageway national speed limit - 750mm traffic cones, spacing 1.5m.  
National speed limit - 1.5m.

Notes:  
1) During darkness, warning lights to BS EN 12369:2006 should be provided in accordance with Table A1.3 (Appendix 1).  
2) If cones have 1.5m spacing, no additional cones are required.  
3) If cones have 0.75m spacing, additional cones are required.  
4) Cones will be required for both standard and relaxation works for road repairs and the laying of new drains.

Standard barrier traffic, including heavy and light vehicles	Standard cone and light vehicles
Heavyweight 3.0 to 3.5m (10 to 11m) in length 3.0 to 3.5m (10 to 11m) in width 3.0 to 3.5m (10 to 11m) in height	Heavyweight 3.0 to 3.5m (10 to 11m) in length 3.0 to 3.5m (10 to 11m) in width 3.0 to 3.5m (10 to 11m) in height

Specials



Notes

RESIDENTS ON THE BYE TO BE PRE-  
WARNED ABOUT RESTRICTED ACCESS /  
EGRESS WHILE JOB IS IN SITU

KEY

- Traffic sign
- Traffic cone
- Working Space
- Pedestrian Barrier

Original drawing size A3 - NTS

Drawing Ref:

ESH