

## **Delegated Decision**

**04<sup>th</sup> January 2022**

**Temporary Traffic Regulation Order**

**Ordinary Decision/Key Decision No.**



---

## **Report of NEIGHBOURHOODS & CLIMATE CHANGE**

**Paul Watson – Interim Strategic Highways Manager, Technical Services**

### **Electoral division(s) affected:**

Sedgefield, Cllr D Brown and Cllr C Lines

### **Purpose of the Report**

To consider a request for temporary traffic regulation by Order on Monday 28<sup>th</sup> March 2022 for the purpose of water supply renewal works on Rear Cleveland View, Fishburn.

### **Recommendation**

It is recommended that the Council exercises its powers under the Road Traffic Regulation Act 1984 to effect a Temporary Traffic Regulation Order to facilitate the proposed works

### **Background**

Works are proposed by Northumbrian Water Ltd to undertake water supply renewal works within the confines of the highway.

### **Options**

Other traffic management arrangements have been considered and the most appropriate method is for temporary road closure for 5 days.

### **Recommendation**

The recommendation is approved and that following, consultations with the Chief of Police, arrangements be made to progress the advertising of Public Notices and sealing of an Order.

---

**Contact:** Heather Freemantle

Tel: 03000 267095

---

---

## **Appendix 1: Implications**

---

### **Legal Implications**

TTRO checked, prepared and advertised via Legal Services

### **Finance**

Costs to be charged to the scheme/applicant.

### **Consultation**

Chief of Police, Local Members, Public Transport Providers (via the Public Transport Team)

### **Equality and Diversity / Public Sector Equality Duty**

N/A

### **Human Rights**

No impact

### **Crime and Disorder**

N/A

### **Climate Change**

N/A

### **Staffing**

Network Management Team

### **Accommodation**

N/A

### **Risk**

N/A

### **Procurement**

Advertising in a public newspaper with costs recharged to the scheme/applicant



# TRAFFIC MANAGEMENT

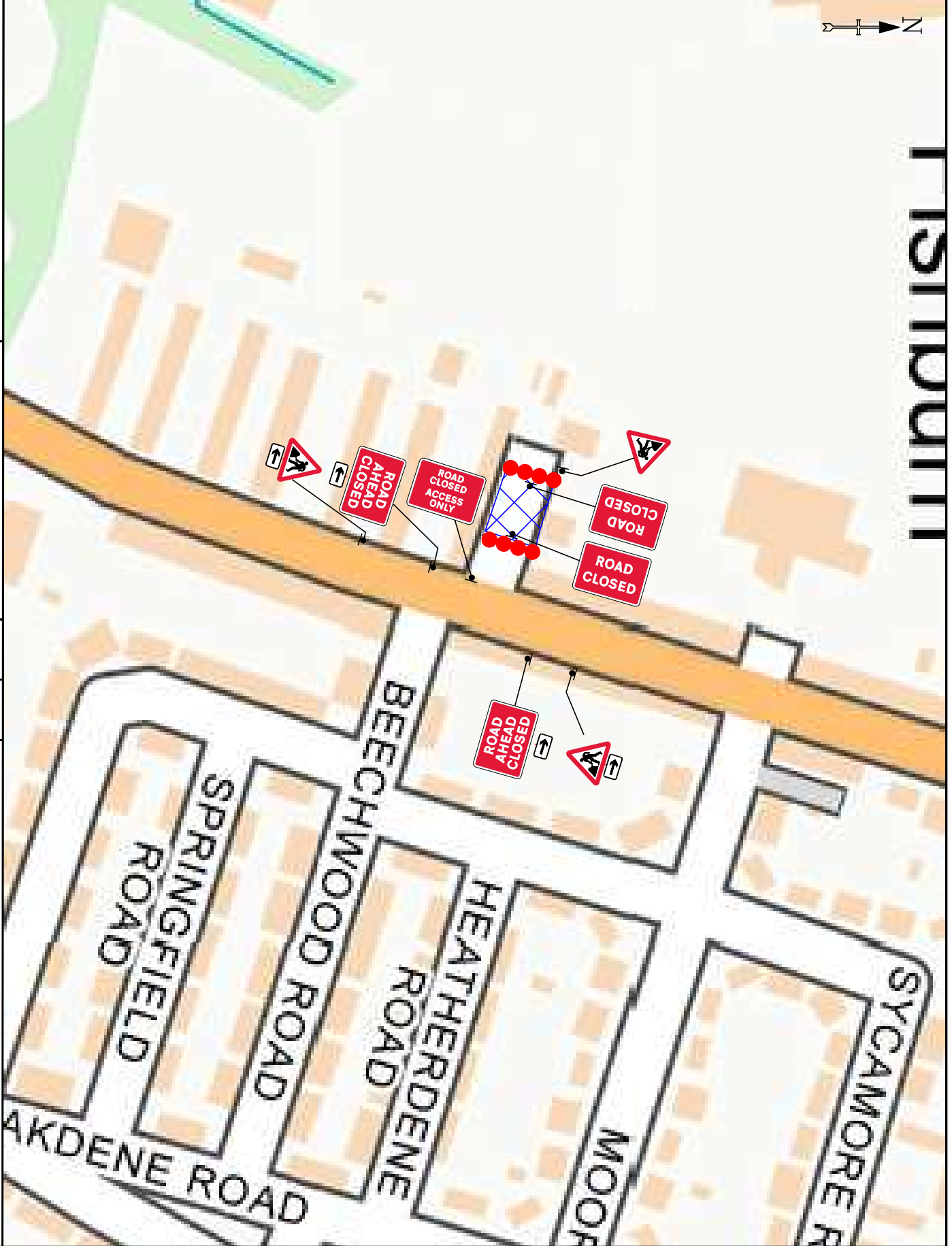

TEMPORARY  
TRAFFIC MANAGEMENT  
30 MPH

Issue	Date
1	14/12/21
Drawn By	JC

ROAD CLOSURE  
CLEVELAND VIEW, FISHBURN, STOCKTON ON TEES  
TS21 4BZ

### DETAIL B

Single dual carriageway 50m or less - 450mm traffic cones, spacing 1.5m. Dual carriageway national speed limit - 750mm traffic cones, spacing 1.5m, radiator 5m.  
Notes:  
1) During darkness, warning lights to BS EN 12352:2006 should be provided in accordance with Table A.3.1 (Appendix 1).  
2) 450mm cones have 1.5m spacing, no reduction.  
3) 750mm cones have 1.5m spacing, no reduction.  
4) 750mm cones will be required for both standard and relaxation works for road repairs and the laying of new road surfaces.

### DETAIL D

Single dual carriageway 50m or less - 450mm traffic cones, spacing 1.5m. Single dual carriageway 50m or more - 750mm traffic cones, spacing 1.5m, radiator 5m.  
Notes:  
1) During darkness, warning lights to BS EN 12352:2006 should be provided in accordance with Table A.3.1 (Appendix 1).  
2) 450mm cones have 1.5m spacing, no reduction.  
3) 750mm cones will be required for both standard and relaxation works for road repairs and the laying of new road surfaces.

Standard traffic signs, including letters and GVM	Proposed cone and sign locations
Temporary warning 52 (S17) triangles	5.2m (17ft) triangles
Temporary warning 53 (S18) triangles with speed sign	5.2m (17ft) triangles with speed sign
Temporary warning 54 (S19) triangles with pedestrian	2.2m (7ft) triangles with pedestrian

### Specials -



### Notes -

RESIDENTS ON CLEVELAND VIEW TO BE PRE WARNED ABOUT RESTRICTED ACCESS / EGRESS WHILE JOB IS IN SITU

### KEY

- Traffic sign
- Traffic cone
- Traffic sign to Diagram 3000:1
- Working Space
- Pedestrian Barrier

Original drawing size A3 - NTS

Drawing Ref: NWL