

Delegated Decision

18th May 2022

Temporary Traffic Regulation Order

Ordinary Decision/Key Decision No.



Report of NEIGHBORHOODS AND CLIMATE CHANGE

Paul Watson – Interim Strategic Highways Manager, Technical Services

Electoral division(s) affected:

Tow Law

Purpose of the Report

To consider a request for temporary traffic regulation by Order on Monday 15th August 2022 at Wooley Terrace, Stanley, Crook for the purpose of Northumbrian Water Ltd to undertake sewer repair works.

Recommendation

It is recommended that the Council exercises its powers under the Road Traffic Regulation Act 1984 to effect a Temporary Traffic Regulation Order to facilitate the proposed works

Background

Sewer repair works are proposed to be undertaken

Options

Other traffic management arrangements have been considered and the most appropriate method is for temporary road closure

Recommendation

The recommendation is approved and that following, consultations with the Chief of Police, arrangements be made to progress the advertising of Public Notices and sealing of an Order.

Contact: Heather Freemantle

Tel: 03000 268110

Appendix 1: Implications

Legal Implications

TTRO checked, prepared and advertised via Legal Services

Finance

Costs to be charged to the scheme/applicant.

Consultation

Chief of Police, Local Members, Public Transport Providers (via the Public Transport Team)

Equality and Diversity / Public Sector Equality Duty

N/A

Human Rights

No impact

Crime and Disorder

N/A

Climate Change

N/A

Staffing

Network Management Team

Accommodation

N/A

Risk

N/A

Procurement

Advertising in a public newspaper with costs recharged to the scheme/applicant

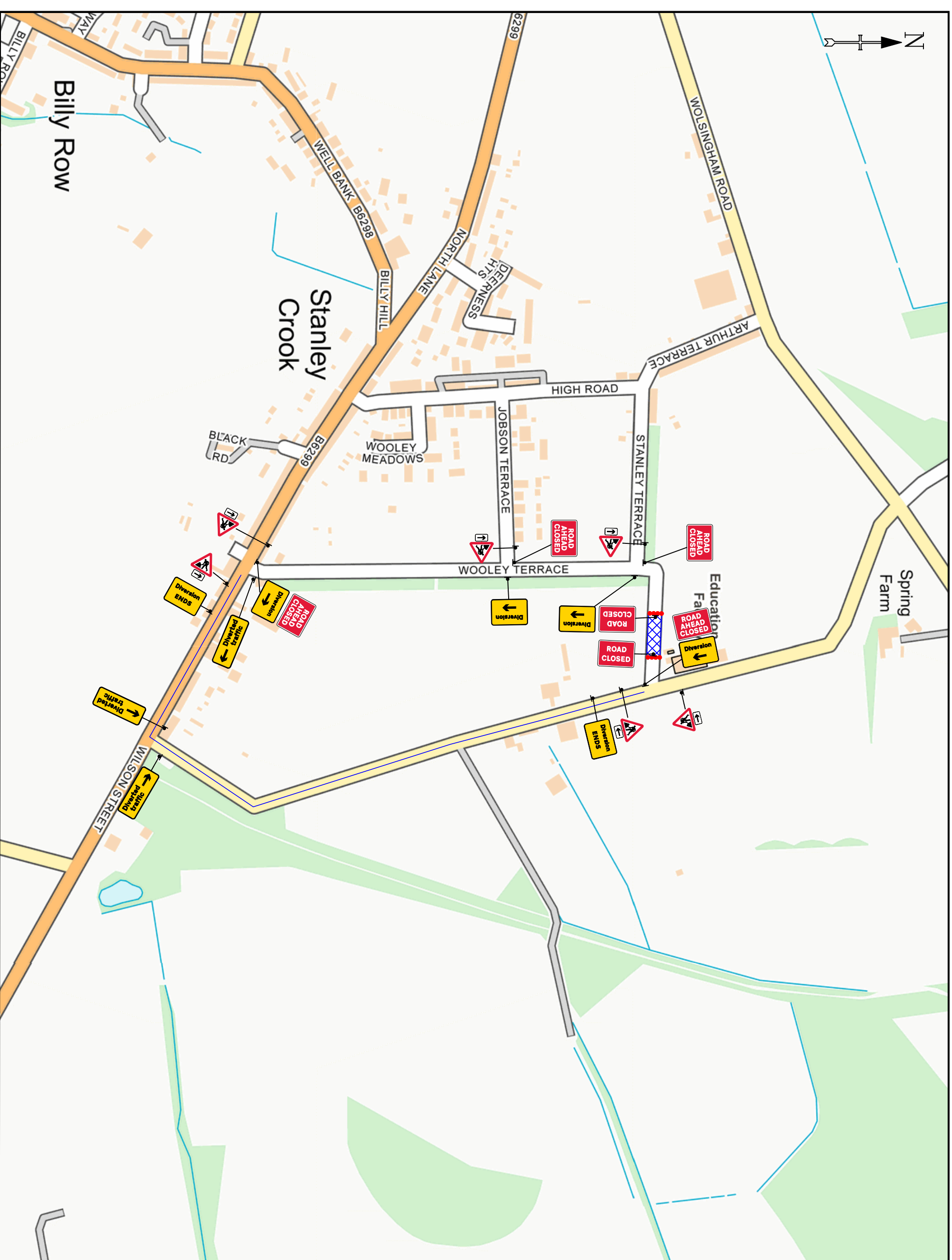
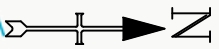

DETAIL B (B)

- Single/Dual carriageway 40mph or less - 450mm traffic cones, spacing 1.5m.
 - Single/Dual carriageway 50mph or more - 750mm traffic cones, spacing 1.5m.
 - Dual carriageway national speed limit - 750mm traffic cones, spacing 1.5m, relaxation 5m.
- Notes:
- 1) During darkness, warning lights to BS EN 12352:2006 should be provided in accordance with Table A1.3 (Appendix 1).
 - 2) 45° tapers have 1.5m spacing, no relaxations.
 - 3) On all roadways and footpaths, standard road shoulders, 1m from the edge of the road, should be marked and standard road works for lead tapers and the flying wall of lane changes.

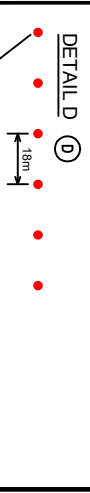

- Notes:
- 1) During darkness, warning lights to BS EN 12352:2006 should be provided in accordance with Table A1.3 (Appendix 1).
 - 2) Detail D applies only to relaxation cases.

	Standard, Normal traffic, including buses and HGVs	Restricted Cars and light vehicles only
Two-way working	6.75 m minimum	5.5 m minimum
Shuttle working	3.25-5.50 m desirable width range	3.25 m desirable minimum width
	3.0 m absolute minimum	2.5 m absolute minimum

Specials -



Notes -

- KEY**
- p Traffic sign
 - Traffic cone
 - ← Traffic signals to Diagram 3000.1
 - Working Space
 - ▨ Pedestrian Barrier



TEMPORARY
TRAFFIC MANAGEMENT
30 MPH

Issue	Date
1	27/04/22
Drawn By	JC

ROAD CLOSURE + DIVERSION
WOOLEY TERRACE, CROOK
DL15 9AN

Original drawing size A3 - NTS
Drawing Ref: ESH