

Delegated Decision

11 January 2023

Temporary Traffic Regulation Order

Ordinary Decision/Key Decision No.



Report of NEIGHBOURHOODS & CLIMATE CHANGE

Paul Watson – Strategic Highways Manager, Technical Services

Electoral division(s) affected:

Shildon & Dene Valley: Cllr S Quinn, Cllr S Townsend. Cllr M Johnson

Purpose of the Report

To consider a request for temporary traffic regulation by Order on Monday 27 February 2023 for the purpose of description new water boundary box works on rear Adamson/Bouch Streets, Shildon.

Recommendation

It is recommended that the Council exercises its powers under the Road Traffic Regulation Act 1984 to effect a Temporary Traffic Regulation Order to facilitate the proposed works

Background

Works are proposed by NWL to undertake new boundary box works within the confines of the highway.

Options

Other traffic management arrangements have been considered and the most appropriate method is for temporary road closure for approx. 5 days.

Recommendation

The recommendation is approved and that following, consultations with the Chief of Police, arrangements be made to progress the advertising of Public Notices and sealing of an Order.

Contact: Steven Galloway

Tel: 03000 267095

Appendix 1: Implications

Legal Implications

TTRO checked, prepared and advertised via Legal Services

Finance

Costs to be charged to the scheme/applicant.

Consultation

Chief of Police, Local Members, Public Transport Providers (via the Public Transport Team)

Equality and Diversity / Public Sector Equality Duty

N/A

Human Rights

No impact

Crime and Disorder

N/A

Climate Change

N/A

Staffing

Network Management Team

Accommodation

N/A

Risk

N/A

Procurement

Advertising in a public newspaper with costs recharged to the scheme/applicant



TRAFFIC MANAGEMENT Road Closure



SINGLE CARRIAGEWAY



WORKS ADDRESS

2 Bouch Street, Shildon, DL4 2JW

DRAWING NOT TO SCALE

DRAWING No - NWL150

DATE

28th December 2022

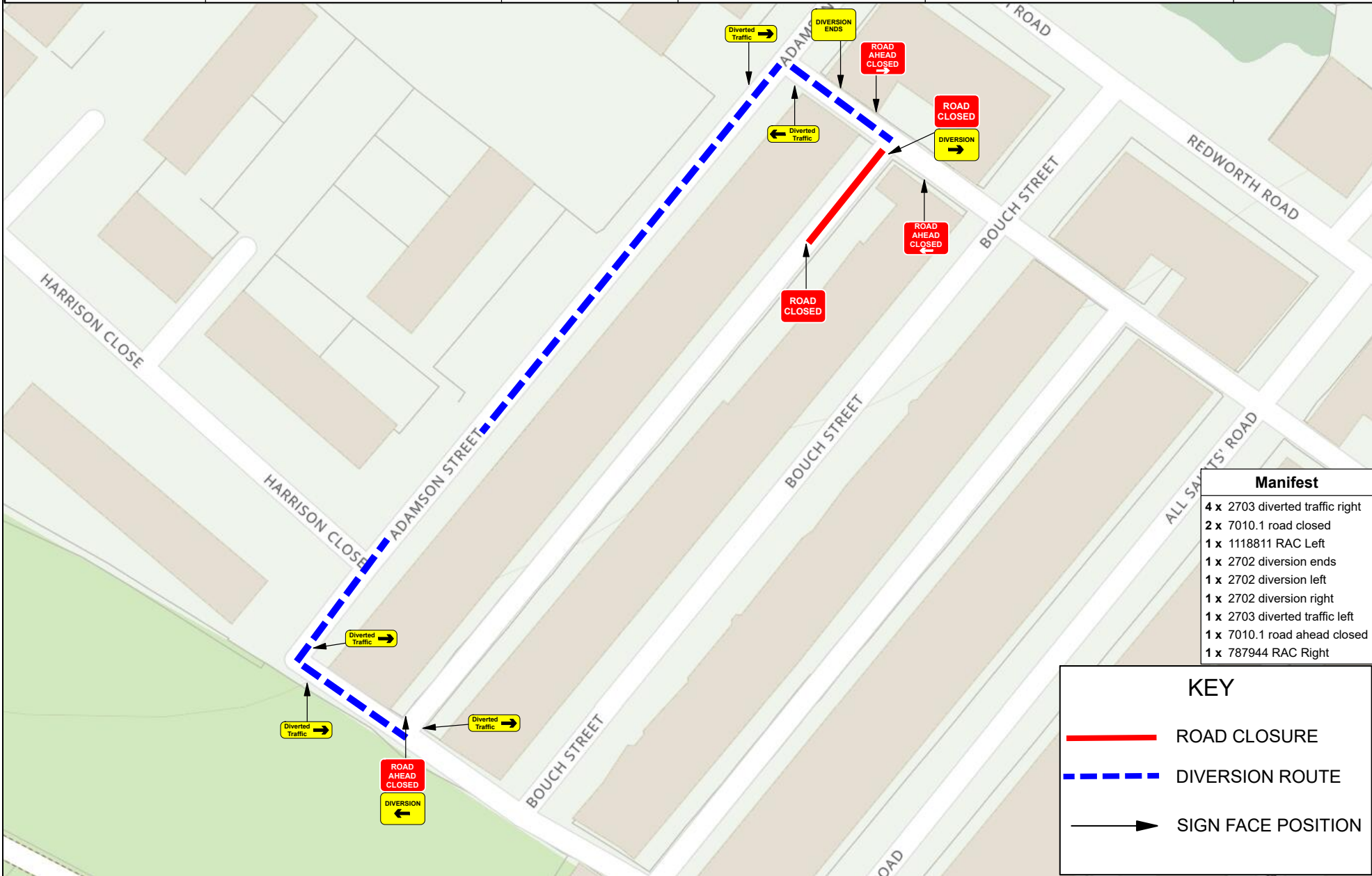

Manifest	
4 x	2703 diverted traffic right
2 x	7010.1 road closed
1 x	1118811 RAC Left
1 x	2702 diversion ends
1 x	2702 diversion left
1 x	2702 diversion right
1 x	2703 diverted traffic left
1 x	7010.1 road ahead closed
1 x	787944 RAC Right

KEY	
	ROAD CLOSURE
	DIVERSION ROUTE
	SIGN FACE POSITION