

# Appendix 5

1  
**Trimdon Founndry**

**PARISH COUNCIL**

*E/C*  
2 Delamere Gardens  
Wordsworth Road  
Easington, Peterlee  
County Durham  
SR8 3PA

Tel: [REDACTED]

Clerk to the Council [REDACTED]

18<sup>TH</sup> DECEMBER 2008

Access & Rights of Way Section  
Environment  
Durham County Council  
County Hall  
Durham  
DH1 5UQ



Dear Sir/Madam

**Village Green – Trimdon Station – TS29 6AB**

On behalf of the Parish Council I wish to enclose evidence in support of a claim of a right of way on land as marked on the enclosed map.

I understand that some time ago, in 2005, a first attempt at registering this land was made by the Parish Council but this was not pursued to completion.

I would appreciate you giving this matter your consideration and look forward to hearing from you at your earliest convenience.

Yours faithfully

[REDACTED]  
Clerk

*27/7/09 - Isn't sufficient evidence & it is only a very short footpath. There are alternatives*

**Esther Gray**

---

**From:** [REDACTED]  
**Sent:** 17 July 2009 11:37  
**To:** [REDACTED]  
**Subject:** Footpath claim, Station House, Trimdon

Hello

Further to our telephone conversation earlier.

Thank you for your completed evidence forms.

Although the landowner has extended their fence, access hasn't been totally blocked. There are no planning issues with the fence. People can walk round it and back onto the former railway line. I know that is not ideal, but at the current time I have a lot of other issues which take priority.

---

have kept the evidence forms on file for future reference.

Regards

[REDACTED]  
Public Rights of Way Officer  
Regeneration and Economic Development  
Durham County Council  
County Durham  
DH1 5UQ

Tel: 0191 383 4536



Making a difference where you live

WILDLIFE AND COUNTRYSIDE ACT 1981 – SECTION 53(3)

PUBLIC RIGHT OF WAY EVIDENCE FORM

The object of this enquiry is simply to reach the truth of the matter, whatever it may be. Witnesses are therefore asked to answer the questions as fully as possible and not to keep back any information, whether for or against the public claim. This is of particular importance if the information is to be of real value in establishing the status of the way.

Name: [Redacted] Occupation: [Redacted]
Address: [Redacted] Day Tel No: [Redacted]
Date of Birth: 16/09/1964
Path runs from: ..... Grid Ref: .....
to: ..... Grid Ref: .....
in the Parish of .....

and is shown on the map attached to this claim (minimum scale 1:25000).

Please tick (✓) the appropriate boxes
Please answer all the questions as fully as possible.

1. Why do you regard this way as public?

I HAVE GROWN UP IN THE VILLAGE AND CAN REMEMBER USING THE PATH SINCE I WAS A CHILD. ALSO I CAN REMEMBER WHEN STONE WAS LAID ALONG THE PATH FOR PEOPLE TO WALK ALONG (MANY YEARS AGO)

2. Is your claim for:

Yes No
(i) Footpath? [X] [ ]
(ii) Bridleway? [ ] [ ]
(iii) Byway Open to all Traffic? [ ] [ ]

3. (a) Have you used it?

	Yes	No	Years during which you have used path							
			*From		To		From		To	
(i) On Foot?	<input checked="" type="checkbox"/>	<input checked="" type="checkbox"/>	1974							2009
(ii) On Horseback?	<input type="checkbox"/>	<input type="checkbox"/>								
(iii) With a Vehicle?	<input type="checkbox"/>	<input type="checkbox"/>								

(b) How many times each year on average?

200 TIMES

\*These boxes are provided to allow you to indicate any variations in use which may have occurred over the years.

(c) Where were you going?

From: MY HOME

To: MY HOME

(d) For what purpose? WALKING, TAKE MY CHILD TO SCHOOL, WALK DOG

4. Have you seen other people using the same route?

Yes  No

If 'Yes' were they:

	Yes	No		Yes	No
(i) Local?	<input checked="" type="checkbox"/>	<input checked="" type="checkbox"/>	(iv) On Foot?	<input checked="" type="checkbox"/>	<input type="checkbox"/>
(ii) Strangers?	<input checked="" type="checkbox"/>	<input type="checkbox"/>	(v) On Horseback?	<input checked="" type="checkbox"/>	<input type="checkbox"/>
(iii) Both?	<input checked="" type="checkbox"/>	<input type="checkbox"/>	(vi) With a Vehicle?	<input checked="" type="checkbox"/>	<input type="checkbox"/>

5. Have you always followed the same route:

Yes  No

If 'No' when was it changed? Year: 2009

And by whom? OWNER OF STATION HOUSE

6. On the route have there ever been:

Are they still there?

	Yes	No	Yes	No
Gates?	<input type="checkbox"/>	<input checked="" type="checkbox"/>	<input type="checkbox"/>	<input type="checkbox"/>
Stiles?	<input checked="" type="checkbox"/>	<input type="checkbox"/>	<input checked="" type="checkbox"/>	<input type="checkbox"/>

If 'Yes', please mark the locations on the plan.

7. Have there ever been any notices along the route?

Yes  No

If 'Yes', what did they say? PRIVATE LAND

DOG FOWLING NOTICE

Are they still there?

Yes  No

If 'Yes', please mark the locations on the plan.

---

8. Have there ever been any obstructions such as hedges  Yes  No  
or fences across the route?

If 'Yes', are they still there?

Yes  No

If 'Yes', please mark the locations on the plan.

---

9. Has any part of the route ever been ploughed or  Yes  No  
cultivated?

If 'Yes', please give details and mark on the location plan.

*TOP SOIL - TO HIDE FOOTPATH*

---

10. At any time when you used the route were you working  Yes  No  
for any owner or occupier of any land over which it  
runs or were you the tenant of any such owner or  
occupier?

If 'Yes', please give the dates, and particulars of the owner  
or occupier.

Yes  No

Were you ever told by him whether he regarded the route  
as a Public Right of Way?

If 'Yes', please give details.

---

11. If you answered 'Yes' to the previous question, have  Yes  No  
you ever used the route during a period when you were  
NOT an employee or tenant of the owner/occupier?

If 'Yes', please give details.

---

12. Did you ever seek or get permission to use the route?  Yes  No

If 'Yes', from whom?

---

13. Have you, or to your knowledge has anyone ever been  Yes  No  
stopped or turned back?

If 'Yes', when and by whom?

---

14. Were you ever told by any owner or occupier or by their  Yes  No  
employee that the route was not public?

If 'Yes', when and by whom?

---

15. Has your use of the route ever been in the exercise of some private right, such as visiting someone who lived along the route, going to your own land or property, or delivering goods?  Yes  No

If 'Yes', please give details? CAN USE THE ROUTE TO VISIT PARENTS

16. Is there any documentary evidence to support your claim, eg. Inclosure Awards, Tithe Maps, Railway Maps, etc?  Yes  No

If 'Yes', please give details? ROUTE IS VISIBLE ON ORDENANCE MAPS

17. (a) Is the route or any part of it enclosed between boundaries, ie. hedges, fences, ditches, walls?  Yes  No

If 'Yes', please give details, including maximum/minimum widths? 2m HIGH FENCE, 15m IN LENGTH, ACROSS FOOTPATH LINE

(b) Is the whole of the width between boundaries used by the public?  Yes  No

If 'No', how much is used? APPROX 1.8m WIDTH

18. If this claim is contested are you prepared to give evidence at the local Public Inquiry which might result?  Yes  No

If 'No', are you prepared to make a statutory declaration on oath as to the truth of the above information?  Yes  No

19. Is there any other information, not given above, which you think will support your claim? (For example, further details of your use of the route as outlined in section 3.) THE ROUTE IS ALSO PART OF DUNHAM OFFROAD

Signed: [REDACTED] (Mr/Mrs/Miss/Ms)

Date: 20/5/09

Person completing this form if different from claimant

Name: .....

Please complete this form, with a map or plan of the route concerned, to Durham County Council at the address on the front page.

For Office Use Only  
No:



Making a difference where you live

**WILDLIFE AND COUNTRYSIDE ACT 1981 - SECTION 53(3)**

**PUBLIC RIGHT OF WAY EVIDENCE FORM**

The object of this enquiry is simply to reach the truth of the matter, whatever it may be. Witnesses are therefore asked to answer the questions as fully as possible and not to keep back any information, whether for or against the public claim. This is of particular importance if the information is to be of real value in establishing the status of the way.

Name: [Redacted] Occupation: NURSE  
Address: [Redacted] Day Tel No: [Redacted]  
TRIMDON STATION Date of Birth: [Redacted]  
Path runs from: ..... Grid Ref: .....  
to: ..... Grid Ref: .....  
in the Parish of .....  
and is shown on the map attached to this claim (minimum scale 1:25000).

Please tick (✓) the appropriate boxes

- a) If this claim is contested are you prepared to give evidence at the Local Public Inquiry which might result?  
Yes  No
- If 'No', are you prepared to make a statutory declaration on oath as to the truth of the above information?  
Yes  No

I understand that the information I have given will become public if this dispute is considered by the County Council's Highways Committee.

Signed (on completion of form):  
[Redacted] ..... (Mr/Mrs/Miss/Ms)

Date: 15-5-09 .....

Person completing this form if different from claimant  
Name: .....

Please complete this form, attaching a map or plan of the route concerned to:

Access and Rights of Way Section, Environment, Durham County Council,  
County Hall, Durham, DH1 5UQ  
(tel: 0191 383 3452)



For Office Use Only  
No:

Please tick (✓) the appropriate boxes  
Please answer all the questions as fully as possible

1. Why do you regard this way as public?

*This has been a public right of way all of my life. We used to play there as children and it was the way to get to Grimston Grange.*

2. (a) Have you used it?

	Yes ✓	No ✓	Years during which you have used path							
			*From	To	From	To	From	To		
(i) On Foot?	<input checked="" type="checkbox"/>	<input type="checkbox"/>	1956	PRESENT						
(ii) On Horseback?	<input type="checkbox"/>	<input type="checkbox"/>								
(iii) With a Vehicle?	<input type="checkbox"/>	<input type="checkbox"/>								

(b) On average how many times each year?

*50*

\*These boxes are provided to allow you to indicate any variations in use which may have occurred over the years.

(c) Where were you going?

From: *TRIMDON STATION*  
To: *TRIMDON GRANGE*

(d) For what purpose?

*A WALK*

3. Have you seen other people using the same route?

Yes  No

If 'Yes' were they:

	Yes ✓	No ✓		Yes ✓	No ✓
(i) Local?	<input checked="" type="checkbox"/>	<input type="checkbox"/>	(iv) On Foot?	<input checked="" type="checkbox"/>	<input type="checkbox"/>
(ii) Strangers?	<input type="checkbox"/>	<input type="checkbox"/>	(v) On Horseback?	<input type="checkbox"/>	<input type="checkbox"/>
(iii) Both?	<input type="checkbox"/>	<input type="checkbox"/>	(vi) With a Vehicle?	<input type="checkbox"/>	<input type="checkbox"/>

4. Have you always followed the same route?

Yes  No

If 'No' when was it changed?

Year: .....

And by whom? .....

For Office Use Only

No:

5. On the route have there ever been:	Are they still there?	
	Yes	No
Gates?	<input checked="" type="checkbox"/>	<input checked="" type="checkbox"/>
Stiles?	<input type="checkbox"/>	<input checked="" type="checkbox"/>

If 'Yes', please mark the locations on the plan.

6. Have there ever been any notices along the route? If 'Yes', what did they say? .....	<input type="checkbox"/> Yes	<input checked="" type="checkbox"/> No
..... Are they still there? If 'Yes', please mark the locations on the plan.	<input type="checkbox"/> Yes	<input type="checkbox"/> No
7. Have there ever been any obstructions such as hedges or fences across the route? If 'Yes', are they still there? If 'Yes', please mark the locations on the plan.	<input type="checkbox"/> Yes	<input checked="" type="checkbox"/> No
	<input type="checkbox"/> Yes	<input type="checkbox"/> No
8. Has any part of the route ever been ploughed or cultivated? If 'Yes', please give details and mark on the location plan.	<input type="checkbox"/> Yes	<input checked="" type="checkbox"/> No
9. At any time when you used the route were you working for any owner or occupier of any land over which it runs or were you the tenant of any such owner or occupier? If 'Yes', please give the dates, and particulars of the owner or occupier. Were you ever told by him whether he regarded the route as a Public Right of Way? If 'Yes', please give details.	<input type="checkbox"/> Yes	<input checked="" type="checkbox"/> No
	<input type="checkbox"/> Yes	<input type="checkbox"/> No

For Office Use Only

No:

<p>10. If you answered 'Yes' to the previous question, have you ever used the route during a period when you were NOT an employee or tenant of the owner/occupier?</p> <p>If 'Yes', please give details.</p>	<p><input type="checkbox"/> Yes      <input type="checkbox"/> No</p>
<p>11. Did you ever seek or get permission to use the route?</p> <p>If 'Yes', from whom?</p>	<p><input type="checkbox"/> Yes      <input checked="" type="checkbox"/> No</p>
<p>12. Have you, or to your knowledge has anyone ever been stopped or turned back?</p> <p>If 'Yes', when and by whom?</p>	<p><input type="checkbox"/> Yes      <input checked="" type="checkbox"/> No</p>
<p>13. Were you ever told by any owner or occupier or by their employee that the route was not public?</p> <p>If 'Yes', when and by whom?</p>	<p><input type="checkbox"/> Yes      <input checked="" type="checkbox"/> No</p>
<p>14. Has your use of the route ever been in the exercise of some private right, such as visiting someone who lived along the route, going to your own land or property, or delivering goods?</p> <p>If 'Yes', please give details?</p>	<p><input type="checkbox"/> Yes      <input checked="" type="checkbox"/> No</p>
<p>15. Is there any documentary evidence to support your claim, eg Inclosure Awards, Tithe Maps, Railway Maps, etc?</p> <p>If 'Yes', please give details?</p>	<p><input type="checkbox"/> Yes      <input checked="" type="checkbox"/> No</p>

For Office Use Only  
No:

<b>16. (a) Is the route or any part of it enclosed between boundaries, ie hedges, fences, ditches, walls?</b>	<input type="checkbox"/> Yes	<input checked="" type="checkbox"/> No
If 'Yes', please give details, including maximum/minium widths?		
<b>(b) Is the whole of the width between boundaries used by the public?</b>	<input checked="" type="checkbox"/> Yes	<input type="checkbox"/> No
If 'No', how much is used?		

**17. Is there any other information, not given above, which you think will support your claim? (For example, further details of your use of the route as outlined in section 3.) (Continue on a separate sheet if necessary.)**

For Office Use Only  
No:



Making a difference where you live

WILDLIFE AND COUNTRYSIDE ACT 1981 -  
SECTION 53(3)

**PUBLIC RIGHT OF WAY EVIDENCE FORM**

The object of this enquiry is simply to reach the truth of the matter, whatever it may be. Witnesses are therefore asked to answer the questions as fully as possible and not to keep back any information, whether for or against the public claim. This is of particular importance if the information is to be of real value in establishing the status of the way.

Name: [Redacted] Occupation: RETIRED  
Address: [Redacted] Day Tel No: .....  
TRIMDON STATION Date of Birth: 3.3.1929  
E DURHAM  
Path runs from: ..... Grid Ref: .....  
to: ..... Grid Ref: .....  
in the Parish of TRIMDON FAWCOURT  
and is shown on the map attached to this claim (minimum scale 1:25000).

Please tick (✓) the appropriate boxes

a) If this claim is contested are you prepared to give evidence at the Local Public Inquiry which might result?  
Yes  No

If 'No', are you prepared to make a statutory declaration on oath as to the truth of the above information?  
Yes  No

I understand that the information I have given will become public if this dispute is considered by the County Council's Highways Committee.

Signed (on completion of form):

[Redacted Signature] (Mr/Mrs/Miss/Ms)

Date: 11. MAY 2009

Person completing this form if different from claimant

Name: [Redacted]

Please complete this form, attaching a map or plan of the route concerned to:

Access and Rights of Way Section, Environment, Durham County Council,  
County Hall, Durham, DH1 5UQ  
(tel: 0191 383 3452)

For Office Use Only

No:

Please tick (✓) the appropriate boxes  
Please answer all the questions as fully as possible

1. Why do you regard this way as public?

.....  
TO THE BEST OF MY KNOWLEDGE IT HAS ALWAYS  
.....  
BEEN A PUBLIC RIGHT OF WAY  
.....

2. (a) Have you used it?

	Yes	No	Years during which you have used path					
			*From	To	From	To	From	To
(i) On Foot?	<input checked="" type="checkbox"/>	<input checked="" type="checkbox"/>	1984	2009				
(ii) On Horseback?	<input type="checkbox"/>	<input type="checkbox"/>						
(iii) With a Vehicle?	<input type="checkbox"/>	<input type="checkbox"/>						

(b) On average how many times each year?

.....  
50.....

\*These boxes are provided to allow you to indicate any variations in use which may have occurred over the years.

(c) Where were you going?

From: ...HOMES.....

To: ...POST OFFICES.....

(d) For what purpose? .....

3. Have you seen other people using the same route?

Yes

No

If 'Yes' were they:

	Yes	No		Yes	No
	<input checked="" type="checkbox"/>	<input checked="" type="checkbox"/>		<input checked="" type="checkbox"/>	<input checked="" type="checkbox"/>
(i) Local?	<input checked="" type="checkbox"/>	<input type="checkbox"/>	(iv) On Foot?	<input checked="" type="checkbox"/>	<input type="checkbox"/>
(ii) Strangers?	<input type="checkbox"/>	<input type="checkbox"/>	(v) On Horseback?	<input type="checkbox"/>	<input type="checkbox"/>
(iii) Both?	<input type="checkbox"/>	<input type="checkbox"/>	(vi) With a Vehicle?	<input type="checkbox"/>	<input type="checkbox"/>

4. Have you always followed the same route:

Yes

No

If 'No' when was it changed?

Year: .....

And by whom? .....

For Office Use Only

No:

5. On the route have there ever been:	Are they still there?	
	Yes	No
Gates?	<input checked="" type="checkbox"/>	<input checked="" type="checkbox"/>
Stiles?	<input type="checkbox"/>	<input type="checkbox"/>

If 'Yes', please mark the locations on the plan.

6. Have there ever been any notices along the route? If 'Yes', what did they say? .....	<input type="checkbox"/> Yes	<input checked="" type="checkbox"/> No
..... Are they still there? If 'Yes', please mark the locations on the plan.	<input type="checkbox"/> Yes	<input checked="" type="checkbox"/> No
7. Have there ever been any obstructions such as hedges or fences across the route?  If 'Yes', are they still there? If 'Yes', please mark the locations on the plan.	<input type="checkbox"/> Yes	<input checked="" type="checkbox"/> No
	<input type="checkbox"/> Yes	<input type="checkbox"/> No
8. Has any part of the route ever been ploughed or cultivated?  If 'Yes', please give details and mark on the location plan.	<input type="checkbox"/> Yes	<input checked="" type="checkbox"/> No
9. At any time when you used the route were you working for any owner or occupier of any land over which it runs or were you the tenant of any such owner or occupier?  If 'Yes', please give the dates, and particulars of the owner or occupier.  Were you ever told by him whether he regarded the route as a Public Right of Way?  If 'Yes', please give details.	<input type="checkbox"/> Yes	<input checked="" type="checkbox"/> No
	<input type="checkbox"/> Yes	<input checked="" type="checkbox"/> No

For Office Use Only

No:

<p>10. If you answered 'Yes' to the previous question, have you ever used the route during a period when you were NOT an employee or tenant of the owner/occupier?</p> <p>If 'Yes', please give details.</p>	<p><input type="checkbox"/> Yes <input checked="" type="checkbox"/> No</p>
<p>11. Did you ever seek or get permission to use the route?</p> <p>If 'Yes', from whom?</p>	<p><input type="checkbox"/> Yes <input checked="" type="checkbox"/> No</p>
<p>12. Have you, or to your knowledge has anyone ever been stopped or turned back?</p> <p>If 'Yes', when and by whom?</p>	<p><input type="checkbox"/> Yes <input checked="" type="checkbox"/> No</p>
<p>13. Were you ever told by any owner or occupier or by their employee that the route was not public?</p> <p>If 'Yes', when and by whom?</p>	<p><input type="checkbox"/> Yes <input checked="" type="checkbox"/> No</p>
<p>14. Has your use of the route ever been in the exercise of some private right, such as visiting someone who lived along the route, going to your own land or property, or delivering goods?</p> <p>If 'Yes', please give details?</p>	<p><input type="checkbox"/> Yes <input checked="" type="checkbox"/> No</p>
<p>15. Is there any documentary evidence to support your claim, eg Inclosure Awards, Tithe Maps, Railway Maps, etc?</p> <p>If 'Yes', please give details?</p>	<p><input type="checkbox"/> Yes <input type="checkbox"/> No</p>



For Office Use Only  
No:

<p>16. (a) Is the route or any part of it enclosed between boundaries, ie hedges, fences, ditches, walls?</p>	<input type="checkbox"/> Yes	<input checked="" type="checkbox"/> No
<p>If 'Yes', please give details, including maximum/minium widths?</p>		
<p>(b) Is the whole of the width between boundaries used by the public?</p>	<input checked="" type="checkbox"/> Yes	<input type="checkbox"/> No
<p>If 'No', how much is used?</p>		

17. Is there any other information, not given above, which you think will support your claim? (For example, further details of your use of the route as outlined in section 3.) (Continue on a separate sheet if necessary.)



Making a difference where you live

For Office Use Only  
No:

WILDLIFE AND COUNTRYSIDE ACT 1981 --  
SECTION 53(3)

**PUBLIC RIGHT OF WAY EVIDENCE FORM**

The object of this enquiry is simply to reach the truth of the matter, whatever it may be. Witnesses are therefore asked to answer the questions as fully as possible and not to keep back any information, whether for or against the public claim. This is of particular importance if the information is to be of real value in establishing the status of the way.

Name: [Redacted] Occupation: RETIRED  
Address: [Redacted] Day Tel No: [Redacted]  
Date of Birth: 27.12.36  
Path runs from: TRIMDON GRANGE  
to: WINGATE  
in the Parish of TRIMDON  
and is shown on the map attached to this claim (minimum scale 1:25000).

Please tick (✓) the appropriate boxes

a) If this claim is contested are you prepared to give evidence at the Local Public Inquiry which might result?  
Yes  No

If 'No', are you prepared to make a statutory declaration on oath as to the truth of the above information?  
Yes  No

I understand that the information I have given will become public if this dispute is considered by the County Council's Highways Committee.

Signed (on completion of form): [Signature] (Mr/Mrs/Miss/Ms)

Date: 10.5.09

Person completing this form if different from claimant  
Name: .....

Please complete this form, attaching a map or plan of the route concerned to:

Access and Rights of Way Section, Environment, Durham County Council,  
County Hall, Durham, DH1 5UQ  
(tel: 0191 383 3452)

For Office Use Only

No:

Please tick (✓) the appropriate boxes  
Please answer all the questions as fully as possible

1. Why do you regard this way as public?

IT HAS BEEN A PUBLIC FOOTPATH  
FOR AS LONG AS I CAN REMEMBER

2. (a) Have you used it?

	Yes ✓	No ✓	Years during which you have used path						
			*From	To	From	To	From	To	
(i) On Foot?	<input checked="" type="checkbox"/>	<input type="checkbox"/>							
(ii) On Horseback?	<input type="checkbox"/>	<input type="checkbox"/>							
(iii) With a Vehicle?	<input type="checkbox"/>	<input type="checkbox"/>							

(b) On average how many times each year?

20

\*These boxes are provided to allow you to indicate any variations in use which may have occurred over the years.

(c) Where were you going?

From: COLLIERY

To: GRANGE

(d) For what purpose?

RECREATION

3. Have you seen other people using the same route?

Yes

No

If 'Yes' were they:

	Yes ✓	No ✓		Yes ✓	No ✓
(i) Local?	<input checked="" type="checkbox"/>	<input type="checkbox"/>	(iv) On Foot?	<input checked="" type="checkbox"/>	<input type="checkbox"/>
(ii) Strangers?	<input type="checkbox"/>	<input type="checkbox"/>	(v) On Horseback?	<input type="checkbox"/>	<input type="checkbox"/>
(iii) Both?	<input type="checkbox"/>	<input type="checkbox"/>	(vi) With a Vehicle?	<input type="checkbox"/>	<input type="checkbox"/>

4. Have you always followed the same route:

Yes

No

If 'No' when was it changed?

Year: .....

And by whom? .....

For Office Use Only

No:

5. On the route have there ever been:	Are they still there?			
	Yes	No	Yes	No
Gates?	<input type="checkbox"/>	<input checked="" type="checkbox"/>	<input type="checkbox"/>	<input type="checkbox"/>
Stiles?	<input type="checkbox"/>	<input type="checkbox"/>	<input type="checkbox"/>	<input type="checkbox"/>

If 'Yes', please mark the locations on the plan.

<b>6. Have there ever been any notices along the route?</b> If 'Yes', what did they say? .....	<input type="checkbox"/> Yes	<input checked="" type="checkbox"/> No
.....  Are they still there? If 'Yes', please mark the locations on the plan.	<input type="checkbox"/> Yes	<input type="checkbox"/> No
<b>7. Have there ever been any obstructions such as hedges or fences across the route?</b>  If 'Yes', are they still there? If 'Yes', please mark the locations on the plan.	<input type="checkbox"/> Yes	<input checked="" type="checkbox"/> No
	<input type="checkbox"/> Yes	<input type="checkbox"/> No
<b>8. Has any part of the route ever been ploughed or cultivated?</b>  If 'Yes', please give details and mark on the location plan.	<input type="checkbox"/> Yes	<input checked="" type="checkbox"/> No
<b>9. At any time when you used the route were you working for any owner or occupier of any land over which it runs or were you the tenant of any such owner or occupier?</b>  If 'Yes', please give the dates, and particulars of the owner or occupier.  Were you ever told by him whether he regarded the route as a Public Right of Way?  If 'Yes', please give details.	<input type="checkbox"/> Yes	<input checked="" type="checkbox"/> No
	<input type="checkbox"/> Yes	<input type="checkbox"/> No

For Office Use Only

No:

<p><b>10. If you answered 'Yes' to the previous question, have you ever used the route during a period when you were NOT an employee or tenant of the owner/occupier?</b></p> <p>If 'Yes', please give details.</p>	<p><input type="checkbox"/> Yes      <input type="checkbox"/> No</p>
<p><b>11. Did you ever seek or get permission to use the route?</b></p> <p>If 'Yes', from whom?</p>	<p><input type="checkbox"/> Yes      <input checked="" type="checkbox"/> No</p>
<p><b>12. Have you, or to your knowledge has anyone ever been stopped or turned back?</b></p> <p>If 'Yes', when and by whom?</p>	<p><input type="checkbox"/> Yes      <input checked="" type="checkbox"/> No</p>
<p><b>13. Were you ever told by any owner or occupier or by their employee that the route was not public?</b></p> <p>If 'Yes', when and by whom?</p>	<p><input type="checkbox"/> Yes      <input checked="" type="checkbox"/> No</p>
<p><b>14. Has your use of the route ever been in the exercise of some private right, such as visiting someone who lived along the route, going to your own land or property, or delivering goods?</b></p> <p>If 'Yes', please give details?</p>	<p><input type="checkbox"/> Yes      <input checked="" type="checkbox"/> No</p>
<p><b>15. Is there any documentary evidence to support your claim, eg Inclosure Awards, Tithe Maps, Railway Maps, etc?</b></p> <p>If 'Yes', please give details?</p>	<p><input type="checkbox"/> Yes      <input type="checkbox"/> No</p>

For Office Use Only

No:

16. (a) Is the route or any part of it enclosed between boundaries, ie hedges, fences, ditches, walls?

Yes

No

FOOTPATH  
WIDTHS:

OF VARYING

If 'Yes', please give details, including maximum/minimum widths?

(b) Is the whole of the width between boundaries used by the public?

Yes

No

If 'No', how much is used?

17. Is there any other information, not given above, which you think will support your claim? (For example, further details of your use of the route as outlined in section 3.) (Continue on a separate sheet if necessary.)

THE REASON I'M OBJECTING TO THE OBSTACLE BEING PLACED ACROSS THE FOOTPATH. IF THIS GO'S ON UNCHECKED ACROSS THE LAND THE COUNTRYSIDE WILL BECOME NO GO AREAS.



Making a difference where you live

For Office Use Only  
No:

WILDLIFE AND COUNTRYSIDE ACT 1981 - SECTION 53(3)

PUBLIC RIGHT OF WAY EVIDENCE FORM

The object of this enquiry is simply to reach the truth of the matter, whatever it may be. Witnesses are therefore asked to answer the questions as fully as possible and not to keep back any information, whether for or against the public claim. This is of particular importance if the information is to be of real value in establishing the status of the way.

Name: [Redacted] Occupation: [Redacted]  
Address: [Redacted] Day Tel No: [Redacted]  
Date of Birth: 16.10.36  
Path runs from: TRIMDON GRANGE  
to: WINGATE  
in the Parish of .....  
and is shown on the map attached to this claim (minimum scale 1:25000).

Please tick (✓) the appropriate boxes

- a) If this claim is contested are you prepared to give evidence at the Local Public Inquiry which might result?  
Yes  No   
If 'No', are you prepared to make a statutory declaration on oath as to the truth of the above information?  
Yes  No

I understand that the information I have given will become public if this dispute is considered by the County Council's Highways Committee.

Signed (on completion of form):

Iw. Broomfield (Mr/Mrs/Miss/Me)

Date: 10.5.09

Person completing this form if different from claimant

Name: .....

Please complete this form, attaching a map or plan of the route concerned to:

Access and Rights of Way Section, Environment, Durham County Council,  
County Hall, Durham, DH1 5UQ  
(tel: 0191 383 3452)

For Office Use Only

No:

Please tick (✓) the appropriate boxes  
Please answer all the questions as fully as possible

1. Why do you regard this way as public?

IT HAS ALWAYS BEEN, AND AS CHILDREN WE USED IT TO GO TO THE MEADOW, (WITH A STREAM) FOR PICNICS BESIDE THE STREAM. LATER I TOOK MY GRANDCHILDREN, TO SHOW WHERE WE SPENT A LOT OF TIME

2. (a) Have you used it?

	Yes	No	Years during which you have used path					
			*From	To	From	To	From	To
(i) On Foot?	<input checked="" type="checkbox"/>	<input type="checkbox"/>						
(ii) On Horseback?	<input type="checkbox"/>	<input type="checkbox"/>						
(iii) With a Vehicle?	<input type="checkbox"/>	<input type="checkbox"/>						

(b) On average how many times each year? .....

\*These boxes are provided to allow you to indicate any variations in use which may have occurred over the years.

(c) Where were you going?

From: TRIMDON GRANGE

To: TRIMDON STATION

(d) For what purpose? WALK WITH GRANDCHILDREN

3. Have you seen other people using the same route?  Yes  No

If 'Yes' were they:

	Yes	No		Yes	No
(i) Local?	<input checked="" type="checkbox"/>	<input type="checkbox"/>	(iv) On Foot?	<input checked="" type="checkbox"/>	<input type="checkbox"/>
(ii) Strangers?	<input type="checkbox"/>	<input type="checkbox"/>	(v) On Horseback?	<input type="checkbox"/>	<input type="checkbox"/>
(iii) Both?	<input type="checkbox"/>	<input type="checkbox"/>	(vi) With a Vehicle?	<input type="checkbox"/>	<input type="checkbox"/>

4. Have you always followed the same route:  Yes  No

If 'No' when was it changed? Year: .....

And by whom? .....



For Office Use Only  
No:

	On the route have there ever been:		Are they still there?	
	Yes	No	Yes	No
Gates?	✓ <input type="checkbox"/>	✓ <input type="checkbox"/>	✓ <input type="checkbox"/>	✓ <input type="checkbox"/>
Stiles?	<input checked="" type="checkbox"/>	<input type="checkbox"/>	<input type="checkbox"/>	<input checked="" type="checkbox"/>

If 'Yes', please mark the locations on the plan.

<p><b>6. Have there ever been any notices along the route?</b> If 'Yes', what did they say? .....</p> <p>.....</p> <p>Are they still there? If 'Yes', please mark the locations on the plan.</p>	<p style="text-align: center;"><input type="checkbox"/> Yes      <input checked="" type="checkbox"/> No</p> <p style="text-align: center;"><input type="checkbox"/> Yes      <input type="checkbox"/> No</p>
<p><b>7. Have there ever been any obstructions such as hedges or fences across the route?</b></p> <p>If 'Yes', are they still there? If 'Yes', please mark the locations on the plan.</p>	<p style="text-align: center;"><input type="checkbox"/> Yes      <input checked="" type="checkbox"/> No</p> <p style="text-align: center;"><input type="checkbox"/> Yes      <input type="checkbox"/> No</p>
<p><b>8. Has any part of the route ever been ploughed or cultivated?</b></p> <p>If 'Yes', please give details and mark on the location plan.</p>	<p style="text-align: center;"><input type="checkbox"/> Yes      <input checked="" type="checkbox"/> No</p>
<p><b>9. At any time when you used the route were you working for any owner or occupier of any land over which it runs or were you the tenant of any such owner or occupier?</b></p> <p>If 'Yes', please give the dates, and particulars of the owner or occupier.</p> <p>Were you ever told by him whether he regarded the route as a Public Right of Way?</p> <p>If 'Yes', please give details.</p>	<p style="text-align: center;"><input type="checkbox"/> Yes      <input checked="" type="checkbox"/> No</p> <p style="text-align: center;"><input type="checkbox"/> Yes      <input checked="" type="checkbox"/> No</p>

For Office Use Only

No:

<p>10. If you answered 'Yes' to the previous question, have you ever used the route during a period when you were NOT an employee or tenant of the owner/occupier?</p> <p>If 'Yes', please give details.</p>	<p><input type="checkbox"/> Yes <input type="checkbox"/> No</p>
<p>11. Did you ever seek or get permission to use the route?</p> <p>If 'Yes', from whom?</p>	<p><input type="checkbox"/> Yes <input checked="" type="checkbox"/> No</p>
<p>12. Have you, or to your knowledge has anyone ever been stopped or turned back?</p> <p>If 'Yes', when and by whom?</p>	<p><input type="checkbox"/> Yes <input checked="" type="checkbox"/> No</p>
<p>13. Were you ever told by any owner or occupier or by their employee that the route was not public?</p> <p>If 'Yes', when and by whom?</p>	<p><input type="checkbox"/> Yes <input checked="" type="checkbox"/> No</p>
<p>14. Has your use of the route ever been in the exercise of some private right, such as visiting someone who lived along the route, going to your own land or property, or delivering goods?</p> <p>If 'Yes', please give details?</p>	<p><input type="checkbox"/> Yes <input checked="" type="checkbox"/> No</p>
<p>15. Is there any documentary evidence to support your claim, eg Inclosure Awards, Tithe Maps, Railway Maps, etc?</p> <p>If 'Yes', please give details?</p>	<p><input type="checkbox"/> Yes <input type="checkbox"/> No</p>



Making a difference where you live

For Office Use Only
No:

**WILDLIFE AND COUNTRYSIDE ACT 1981 –  
SECTION 53(3)**

**PUBLIC RIGHT OF WAY EVIDENCE FORM**

The object of this enquiry is simply to reach the truth of the matter, whatever it may be. Witnesses are therefore asked to answer the questions as fully as possible and not to keep back any information, whether for or against the public claim. This is of particular importance if the information is to be of real value in establishing the status of the way.

Name: [Redacted] Occupation: RETIRED  
 Address: [Redacted] Day Tel No: [Redacted]

Date of Birth: 12.11.46  
 Path runs from: TRIMDON STATION Grid Ref: .....  
 to: TRIMDON CREST Grid Ref: .....  
 in the Parish of TRIMDON FOUNDRY PARISH

and is shown on the map attached to this claim (minimum scale 1:25000).

Please tick (✓) the appropriate boxes

a) If this claim is contested are you prepared to give evidence at the Local Public Inquiry which might result?  
 Yes  No

If 'No', are you prepared to make a statutory declaration on oath as to the truth of the above information?  
 Yes  No

I understand that the information I have given will become public if this dispute is considered by the County Council's Highways Committee.

Signed (on completion of form):

[Redacted Signature] (Mr/Mrs/Miss/Ms)

Date: 10/3/09

Person completing this form if different from claimant

Name: .....

Please complete this form, attaching a map or plan of the route concerned to:

Access and Rights of Way Section, Environment, Durham County Council,  
 County Hall, Durham, DH1 5UQ  
 (tel: 0191 383 3452)

For Office Use Only

No:

Please tick (✓) the appropriate boxes  
Please answer all the questions as fully as possible

1. Why do you regard this way as public?

Residents have used this path for years. I used to walk to my house when I lived at Station Cottages

2. (a) Have you used it?

	Yes ✓	No ✓	Years during which you have used path					
			*From	To	From	To	From	To
(i) On Foot?	<input checked="" type="checkbox"/>	<input type="checkbox"/>						
(ii) On Horseback?	<input type="checkbox"/>	<input type="checkbox"/>						
(iii) With a Vehicle?	<input type="checkbox"/>	<input type="checkbox"/>						

(b) On average how many times each year? .....

\*These boxes are provided to allow you to indicate any variations in use which may have occurred over the years.

(c) Where were you going?

From: TRIMDON STATION  
To: TRIMDON GRANGE

(d) For what purpose? PLEASEUSE FOR WALKING HOME

3. Have you seen other people using the same route?  Yes  No  
If 'Yes' were they:

	Yes ✓	No ✓		Yes ✓	No ✓
(i) Local?	<input checked="" type="checkbox"/>	<input type="checkbox"/>	(iv) On Foot?	<input checked="" type="checkbox"/>	<input type="checkbox"/>
(ii) Strangers?	<input checked="" type="checkbox"/>	<input type="checkbox"/>	(v) On Horseback?	<input checked="" type="checkbox"/>	<input type="checkbox"/>
(iii) Both?	<input checked="" type="checkbox"/>	<input type="checkbox"/>	(vi) With a Vehicle?	<input type="checkbox"/>	<input type="checkbox"/>

4. Have you always followed the same route:  Yes  No

If 'No' when was it changed? Year: .....

And by whom? .....

For Office Use Only

No:

5. On the route have there ever been:

Are they still there?

	Yes ✓	No ✓	Yes ✓	No ✓
Gates?	<input type="checkbox"/>	<input checked="" type="checkbox"/>	<input type="checkbox"/>	<input type="checkbox"/>
Stiles?	<input type="checkbox"/>	<input checked="" type="checkbox"/>	<input type="checkbox"/>	<input type="checkbox"/>

If 'Yes', please mark the locations on the plan.

<p>6. Have there ever been any notices along the route? If 'Yes', what did they say? .....</p> <p><i>PUBLIC FOOTPATH</i></p> <p>Are they still there? If 'Yes', please mark the locations on the plan.</p>	<p><input checked="" type="checkbox"/> Yes      <input type="checkbox"/> No</p> <p><input type="checkbox"/> Yes      <input checked="" type="checkbox"/> No</p>
<p>7. Have there ever been any obstructions such as hedges or fences across the route?</p> <p>If 'Yes', are they still there? If 'Yes', please mark the locations on the plan.</p>	<p><input type="checkbox"/> Yes      <input checked="" type="checkbox"/> No</p> <p><input checked="" type="checkbox"/> Yes      <input type="checkbox"/> No</p>
<p>8. Has any part of the route ever been ploughed or cultivated?</p> <p>If 'Yes', please give details and mark on the location plan.</p>	<p><input type="checkbox"/> Yes      <input checked="" type="checkbox"/> No</p>
<p>9. At any time when you used the route were you working for any owner or occupier of any land over which it runs or were you the tenant of any such owner or occupier?</p> <p>If 'Yes', please give the dates, and particulars of the owner or occupier.</p> <p>Were you ever told by him whether he regarded the route as a Public Right of Way?</p> <p>If 'Yes', please give details.</p>	<p><input type="checkbox"/> Yes      <input checked="" type="checkbox"/> No</p> <p><input type="checkbox"/> Yes      <input type="checkbox"/> No</p>

For Office Use Only

No:

<p>10. If you answered 'Yes' to the previous question, have you ever used the route during a period when you were NOT an employee or tenant of the owner/occupier?</p> <p>If 'Yes', please give details.</p>	<p><input type="checkbox"/> Yes      <input type="checkbox"/> No</p>
<p>11. Did you ever seek or get permission to use the route?</p> <p>If 'Yes', from whom?</p>	<p><input type="checkbox"/> Yes      <input checked="" type="checkbox"/> No</p>
<p>12. Have you, or to your knowledge has anyone ever been stopped or turned back?</p> <p>If 'Yes', when and by whom?</p>	<p><input type="checkbox"/> Yes      <input checked="" type="checkbox"/> No</p>
<p>13. Were you ever told by any owner or occupier or by their employee that the route was not public?</p> <p>If 'Yes', when and by whom?</p>	<p><input type="checkbox"/> Yes      <input checked="" type="checkbox"/> No</p>
<p>14. Has your use of the route ever been in the exercise of some private right, such as visiting someone who lived along the route, going to your own land or property, or delivering goods?</p> <p>If 'Yes', please give details?</p>	<p><input checked="" type="checkbox"/> Yes      <input type="checkbox"/> No</p>
<p>15. Is there any documentary evidence to support your claim, eg Inclosure Awards, Tithe Maps, Railway Maps, etc?</p> <p>If 'Yes', please give details?</p>	<p><input checked="" type="checkbox"/> Yes      <input type="checkbox"/> No</p>

*WHEN I LIVED THERE 1966-1967*

*OLD RAILWAY MAPS*

For Office Use Only

No:



Making a difference where you live

WILDLIFE AND COUNTRYSIDE ACT 1981 - SECTION 53(3)

PUBLIC RIGHT OF WAY EVIDENCE FORM

The object of this enquiry is simply to reach the truth of the matter, whatever it may be. Witnesses are therefore asked to answer the questions as fully as possible and not to keep back any information, whether for or against the public claim. This is of particular importance if the information is to be of real value in establishing the status of the way.

Name: [Redacted] Occupation: RETIRED
Address: [Redacted] Day Tel No: [Redacted]
Date of Birth: 03-10-1943
Path runs from: TRIMDON STATION to: TRIMDON GRANGE
in the Parish of: DRAFHILL (TRIMDON FOUNDRY)
and is shown on the map attached to this claim (minimum scale 1:25000).

Please tick (✓) the appropriate boxes

- a) If this claim is contested are you prepared to give evidence at the Local Public Inquiry which might result?
Yes [checked] No [ ]
If 'No', are you prepared to make a statutory declaration on oath as to the truth of the above information?
Yes [checked] No [ ]

I understand that the information I have given will become public if this dispute is considered by the County Council's Highways Committee.

Signed (on completion of form):

[Redacted Signature] (Mr/Ms/Ms/Ms/Ms)

Date: 7 May 2009

Person completing this form if different from claimant

Name: DAVID UPTON

Please complete this form, attaching a map or plan of the route concerned to:

Access and Rights of Way Section, Environment, Durham County Council, County Hall, Durham, DH1 5UQ (tel: 0191 383 3452)

For Office Use Only  
No:

Please tick (✓) the appropriate boxes  
Please answer all the questions as fully as possible

1. Why do you regard this way as public?

It has a tarmac path on the part that has been covered by soil.

2. (a) Have you used it?

	Yes ✓	No ✓	Years during which you have used path					
			*From	To	From	To	From	To
(i) On Foot?	<input checked="" type="checkbox"/>	<input type="checkbox"/>	1950	2009				
(ii) On Horseback?	<input type="checkbox"/>	<input type="checkbox"/>						
(iii) With a Vehicle?	<input type="checkbox"/>	<input type="checkbox"/>						

(b) On average how many times each year? 250

\*These boxes are provided to allow you to indicate any variations in use which may have occurred over the years.

(c) Where were you going? From: TRIMDON STATION To: TRIMDON GRANGE

(d) For what purpose? because

3. Have you seen other people using the same route?  Yes  No  
If 'Yes' were they:

	Yes ✓	No ✓		Yes ✓	No ✓
(i) Local?	<input checked="" type="checkbox"/>	<input type="checkbox"/>	(iv) On Foot?	<input checked="" type="checkbox"/>	<input type="checkbox"/>
(ii) Strangers?	<input checked="" type="checkbox"/>	<input type="checkbox"/>	(v) On Horseback?	<input checked="" type="checkbox"/>	<input type="checkbox"/>
(iii) Both?	<input checked="" type="checkbox"/>	<input type="checkbox"/>	(vi) With a Vehicle?	<input type="checkbox"/>	<input checked="" type="checkbox"/>

4. Have you always followed the same route:  Yes  No

If 'No' when was it changed? Year: .....

And by whom? .....



5. On the route have there ever been:	Are they still there?	
	Yes	No
Gates?	<input checked="" type="checkbox"/>	<input checked="" type="checkbox"/>
Stiles?	<input type="checkbox"/>	<input checked="" type="checkbox"/>

If 'Yes', please mark the locations on the plan.

<p>6. Have there ever been any notices along the route? If 'Yes', what did they say? .....</p> <p><i>Yes this person has suddenly put up private land</i></p> <p>Are they still there? If 'Yes', please mark the locations on the plan.</p>	<p><input checked="" type="checkbox"/> Yes      <input type="checkbox"/> No</p> <p><input checked="" type="checkbox"/> Yes      <input type="checkbox"/> No</p>
<p>7. Have there ever been any obstructions such as hedges or fences across the route?</p> <p>If 'Yes', are they still there? If 'Yes', please mark the locations on the plan.</p>	<p><input checked="" type="checkbox"/> Yes      <input type="checkbox"/> No</p> <p><input checked="" type="checkbox"/> Yes      <input type="checkbox"/> No</p>
<p>8. Has any part of the route ever been ploughed or cultivated? <i>they are trying to</i></p> <p>If 'Yes', please give details and mark on the location plan.</p>	<p><input checked="" type="checkbox"/> Yes      <input type="checkbox"/> No</p>
<p>9. At any time when you used the route were you working for any owner or occupier of any land over which it runs or were you the tenant of any such owner or occupier?</p> <p>If 'Yes', please give the dates, and particulars of the owner or occupier.</p> <p>Were you ever told by him whether he regarded the route as a Public Right of Way?</p> <p>If 'Yes', please give details.</p>	<p><input type="checkbox"/> Yes      <input checked="" type="checkbox"/> No</p> <p><input type="checkbox"/> Yes      <input type="checkbox"/> No</p>

For Office Use Only

No:

<p>10. If you answered 'Yes' to the previous question, have you ever used the route during a period when you were NOT an employee or tenant of the owner/occupier?</p> <p>If 'Yes', please give details.</p>	<p><input type="checkbox"/> Yes <input type="checkbox"/> No</p>
<p>11. Did you ever seek or get permission to use the route?</p> <p>If 'Yes', from whom?</p>	<p><input type="checkbox"/> Yes <input checked="" type="checkbox"/> No</p>
<p>12. Have you, or to your knowledge has anyone ever been stopped or turned back?</p> <p>If 'Yes', when and by whom?</p> <p><i>cannot get access they have <del>blocked</del> the right of way with fences</i></p>	<p><input checked="" type="checkbox"/> Yes <input type="checkbox"/> No</p>
<p>13. Were you ever told by any owner or occupier or by their employee that the route was not public?</p> <p>If 'Yes', when and by whom?</p> <p><i>But they have put fences up and put unauthorised notices up.</i></p>	<p><input type="checkbox"/> Yes <input checked="" type="checkbox"/> No</p>
<p>14. Has your use of the route ever been in the exercise of some private right, such as visiting someone who lived along the route, going to your own land or property, or delivering goods?</p> <p>If 'Yes', please give details?</p> <p><i>her use and I have friends in Tendon Grange</i></p>	<p><input checked="" type="checkbox"/> Yes <input type="checkbox"/> No</p>
<p>15. Is there any documentary evidence to support your claim, eg Inclosure Awards, Tithe Maps, Railway Maps, etc?</p> <p>If 'Yes', please give details?</p> <p><i>Maps Land Registry Railway Maps as far as I am aware.</i></p>	<p><input checked="" type="checkbox"/> Yes <input type="checkbox"/> No</p>

For Office Use Only

No:

<p>16. (a) Is the route or any part of it enclosed between boundaries, ie hedges, fences, ditches, walls?</p> <p>If 'Yes', please give details, including maximum/minium widths?</p>	<p><input type="checkbox"/> Yes</p> <p><input type="checkbox"/> No</p>
<p>(b) Is the whole of the width between boundaries used by the public?</p> <p>If 'No', how much is used?</p>	<p><input checked="" type="checkbox"/> Yes</p> <p><input type="checkbox"/> No</p>

17. Is there any other information, not given above, which you think will support your claim? (For example, further details of your use of the route as outlined in section 3.) (Continue on a separate sheet if necessary.)

There has been a footpath there since I was a boy and I am 65 years old now, The route was changed ~~after~~ after the tunnels ~~(was)~~ were taken down approximately 25 yrs ago when steps were put in to make a continuous walkway from Station Town on to Kelloe and beyond.

D. *[Signature]*

For Office Use Only  
No:



Making a difference where you live

**WILDLIFE AND COUNTRYSIDE ACT 1981 - SECTION 53(3)**

**PUBLIC RIGHT OF WAY EVIDENCE FORM**

The object of this enquiry is simply to reach the truth of the matter, whatever it may be. Witnesses are therefore asked to answer the questions as fully as possible and not to keep back any information, whether for or against the public claim. This is of particular importance if the information is to be of real value in establishing the status of the way.

Name: [Redacted] Occupation: RETIRED  
Address: [Redacted] Day Tel No: [Redacted]  
TRIMDON STATION CO. DURHAM Date of Birth: 14-6-1939  
Path runs from: TRIMDON STATION Grid Ref: .....  
to: TRIMDON GRANGE Grid Ref: .....  
in the Parish of TRIMDON FOUNDLY  
and is shown on the map attached to this claim (minimum scale 1:25000).

Please tick (✓) the appropriate boxes

- a) If this claim is contested are you prepared to give evidence at the Local Public Inquiry which might result?  
Yes  No   
If 'No', are you prepared to make a statutory declaration on oath as to the truth of the above information?  
Yes  No

I understand that the information I have given will become public if this dispute is considered by the County Council's Highways Committee.

Signed (on completion of form):

[Redacted Signature] ..... (Mr/Mrs/Miss/Ms)

Date: 4-5-2009

Person completing this form if different from claimant

Name: .....

Please complete this form, attaching a map or plan of the route concerned to:

Access and Rights of Way Section, Environment, Durham County Council,  
County Hall, Durham, DH1 5UQ  
(tel: 0191 383 3452)

For Office Use Only

No:

Please tick (✓) the appropriate boxes  
Please answer all the questions as fully as possible

1. Why do you regard this way as public?

*It has been a public right of way as long as I can remember 1945-2009*

2. (a) Have you used it?

	Yes ✓	No ✓	Years during which you have used path					
			*From	To	From	To	From	To
(i) On Foot?	<input checked="" type="checkbox"/>	<input type="checkbox"/>	1945	2009				
(ii) On Horseback?	<input type="checkbox"/>	<input type="checkbox"/>						
(iii) With a Vehicle?	<input type="checkbox"/>	<input type="checkbox"/>						

(b) On average how many times each year?

*50*

\*These boxes are provided to allow you to indicate any variations in use which may have occurred over the years.

(c) Where were you going?

From: *TRIMDON STATION*

To: *TRIMDON GRANGE*

(d) For what purpose?

*WALKING TO GRAND-PARENTS*

3. Have you seen other people using the same route?

Yes

No

If 'Yes' were they:

	Yes ✓	No ✓		Yes ✓	No ✓
(i) Local?	<input checked="" type="checkbox"/>	<input type="checkbox"/>	(iv) On Foot?	<input checked="" type="checkbox"/>	<input type="checkbox"/>
(ii) Strangers?	<input checked="" type="checkbox"/>	<input type="checkbox"/>	(v) On Horseback?	<input type="checkbox"/>	<input type="checkbox"/>
(iii) Both?	<input checked="" type="checkbox"/>	<input type="checkbox"/>	(vi) With a Vehicle?	<input type="checkbox"/>	<input type="checkbox"/>

4. Have you always followed the same route?

Yes

No

If 'No' when was it changed?

Year: .....

And by whom? .....

5. On the route have there ever been:	Are they still there?	
	Yes	No
Gates?	<input checked="" type="checkbox"/>	<input checked="" type="checkbox"/>
Stiles?	<input type="checkbox"/>	<input type="checkbox"/>

If 'Yes', please mark the locations on the plan.

<p>6. Have there ever been any notices along the route?                      If 'Yes', what did they say? ...<i>FOOT PATH</i>.....                      .....</p> <p>Are they still there?                      If 'Yes', please mark the locations on the plan.</p>	<p><input checked="" type="checkbox"/> Yes      <input type="checkbox"/> No</p> <p><input type="checkbox"/> Yes      <input type="checkbox"/> No</p>
<p>7. Have there ever been any obstructions such as hedges or fences across the route?</p> <p>If 'Yes', are they still there?                      If 'Yes', please mark the locations on the plan.</p>	<p><input type="checkbox"/> Yes      <input checked="" type="checkbox"/> No</p> <p><input type="checkbox"/> Yes      <input type="checkbox"/> No</p>
<p>8. Has any part of the route ever been ploughed or cultivated?</p> <p>If 'Yes', please give details and mark on the location plan.</p>	<p><input type="checkbox"/> Yes      <input checked="" type="checkbox"/> No</p>
<p>9. At any time when you used the route were you working for any owner or occupier of any land over which it runs or were you the tenant of any such owner or occupier?</p> <p>If 'Yes', please give the dates, and particulars of the owner or occupier.</p> <p>Were you ever told by him whether he regarded the route as a Public Right of Way?</p> <p>If 'Yes', please give details.</p>	<p><input type="checkbox"/> Yes      <input checked="" type="checkbox"/> No</p> <p><input type="checkbox"/> Yes      <input type="checkbox"/> No</p>

For Office Use Only

No:

<p>10. If you answered 'Yes' to the previous question, have you ever used the route during a period when you were NOT an employee or tenant of the owner/occupier?</p> <p>If 'Yes', please give details.</p>	<p><input type="checkbox"/> Yes      <input type="checkbox"/> No</p>
<p>11. Did you ever seek or get permission to use the route?</p> <p>If 'Yes', from whom?</p>	<p><input type="checkbox"/> Yes      <input checked="" type="checkbox"/> No</p>
<p>12. Have you, or to your knowledge has anyone ever been stopped or turned back?</p> <p>If 'Yes', when and by whom?</p>	<p><input type="checkbox"/> Yes      <input checked="" type="checkbox"/> No</p>
<p>13. Were you ever told by any owner or occupier or by their employee that the route was not public?</p> <p>If 'Yes', when and by whom?</p>	<p><input type="checkbox"/> Yes      <input checked="" type="checkbox"/> No</p>
<p>14. Has your use of the route ever been in the exercise of some private right, such as visiting someone who lived along the route, going to your own land or property, or delivering goods?</p> <p>If 'Yes', please give details?</p>	<p><input checked="" type="checkbox"/> Yes      <input type="checkbox"/> No</p>
<p>15. Is there any documentary evidence to support your claim, eg Inclosure Awards, Tithe Maps, Railway Maps, etc?</p> <p>If 'Yes', please give details?</p> <p><i>Refer to Parish Council</i></p>	<p><input type="checkbox"/> Yes      <input checked="" type="checkbox"/> No</p>

For Office Use Only

No:

<p><b>16. (a) Is the route or any part of it enclosed between boundaries, ie hedges, fences, ditches, walls?</b></p> <p>If 'Yes', please give details, including maximum/minium widths?</p> <p><b>(b) Is the whole of the width between boundaries used by the public?</b></p> <p>If 'No', how much is used?</p>	<p><input type="checkbox"/> Yes      <input checked="" type="checkbox"/> No</p> <p><input checked="" type="checkbox"/> Yes      <input type="checkbox"/> No</p>
--	---

**17. Is there any other information, not given above, which you think will support your claim? (For example, further details of your use of the route as outlined in section 3.) (Continue on a separate sheet if necessary.)**



For Office Use Only  
No:



Making a difference where you live

WILDLIFE AND COUNTRYSIDE ACT 1981 - SECTION 53(3)

PUBLIC RIGHT OF WAY EVIDENCE FORM

The object of this enquiry is simply to reach the truth of the matter, whatever it may be. Witnesses are therefore asked to answer the questions as fully as possible and not to keep back any information, whether for or against the public claim. This is of particular importance if the information is to be of real value in establishing the status of the way.

Name: [Redacted] Occupation: RETIRED  
Address: [Redacted] Day Tel No: [Redacted]  
TRIMDON STATION Date of Birth: 16-08-41  
Path runs from: TRIMDON STATION Grid Ref: .....  
to: TRIMDON GRANOE Grid Ref: .....  
in the Parish of EASINGTON (TRIMDON FOUNDRY)

and is shown on the map attached to this claim (minimum scale 1:25000).

Please tick (✓) the appropriate boxes

- a) If this claim is contested are you prepared to give evidence at the Local Public Inquiry which might result?  
Yes  No   
If 'No', are you prepared to make a statutory declaration on oath as to the truth of the above information?  
Yes  No

I understand that the information I have given will become public if this dispute is considered by the County Council's Highways Committee.

Signed (on completion of form):  
[Redacted] (Mr/Mrs/Miss/Ms)

Date: 08-05-09

Person completing this form if different from claimant  
Name: .....

Please complete this form, attaching a map or plan of the route concerned to:

Access and Rights of Way Section, Environment, Durham County Council,  
County Hall, Durham, DH1 5UQ  
(tel: 0191 383 3452)

For Office Use Only

No:

Please tick (✓) the appropriate boxes  
Please answer all the questions as fully as possible

1. Why do you regard this way as public?

WHEN THE RAILWAYS CLOSED THE PATH.  
WAS OPENED AS A MEANS OF ACCESS  
FOR THE PUBLIC WHICH IS TRAVELLED DAILY

2. (a) Have you used it?

	Yes	No	Years during which you have used path					
			*From	To	From	To	From	To
(i) On Foot?	<input checked="" type="checkbox"/>	<input type="checkbox"/>	1990	2009				
(ii) On Horseback?	<input type="checkbox"/>	<input type="checkbox"/>						
(iii) With a Vehicle?	<input type="checkbox"/>	<input type="checkbox"/>						

(b) On average how many times each year? .....

\*These boxes are provided to allow you to indicate any variations in use which may have occurred over the years.

(c) Where were you going?

From: TRIMDON STATION  
To: TRIMDON GRANGE

(d) For what purpose? SOCIAL WALKING AWAY FROM TRAFFIC.

3. Have you seen other people using the same route?  Yes  No

If 'Yes' were they:

	Yes	No		Yes	No
(i) Local?	<input checked="" type="checkbox"/>	<input type="checkbox"/>	(iv) On Foot?	<input checked="" type="checkbox"/>	<input type="checkbox"/>
(ii) Strangers?	<input type="checkbox"/>	<input type="checkbox"/>	(v) On Horseback?	<input type="checkbox"/>	<input type="checkbox"/>
(iii) Both?	<input checked="" type="checkbox"/>	<input type="checkbox"/>	(vi) With a Vehicle?	<input type="checkbox"/>	<input type="checkbox"/>

4. Have you always followed the same route:  Yes  No

If 'No' when was it changed? Year: 2009

And by whom? RESIDENTS OF STATION HOUSE

5. On the route have there ever been:	Are they still there?	
	Yes	No
Gates?	<input checked="" type="checkbox"/>	<input checked="" type="checkbox"/>
Stiles?	<input type="checkbox"/>	<input type="checkbox"/>

If 'Yes', please mark the locations on the plan.

<p>6. <b>Have there ever been any notices along the route?</b> If 'Yes', what did they say? .....</p> <p>.....</p> <p>Are they still there? If 'Yes', please mark the locations on the plan.</p>	<p><input type="checkbox"/> Yes      <input type="checkbox"/> No</p> <p><input type="checkbox"/> Yes      <input type="checkbox"/> No</p>
<p>7. <b>Have there ever been any obstructions such as hedges or fences across the route?</b></p> <p>If 'Yes', are they still there? If 'Yes', please mark the locations on the plan.</p>	<p><input type="checkbox"/> Yes      <input type="checkbox"/> No</p> <p><input type="checkbox"/> Yes      <input type="checkbox"/> No</p>
<p>8. <b>Has any part of the route ever been ploughed or cultivated?</b></p> <p>If 'Yes', please give details and mark on the location plan.</p>	<p><input type="checkbox"/> Yes      <input type="checkbox"/> No</p>
<p>9. <b>At any time when you used the route were you working for any owner or occupier of any land over which it runs or were you the tenant of any such owner or occupier?</b></p> <p>If 'Yes', please give the dates, and particulars of the owner or occupier.</p> <p>Were you ever told by him whether he regarded the route as a Public Right of Way?</p> <p>If 'Yes', please give details.</p>	<p><input type="checkbox"/> Yes      <input type="checkbox"/> No</p> <p><input type="checkbox"/> Yes      <input type="checkbox"/> No</p>

For Office Use Only

No:

<p>10. If you answered 'Yes' to the previous question, have you ever used the route during a period when you were NOT an employee or tenant of the owner/occupier?</p> <p>If 'Yes', please give details.</p>	<p><input checked="" type="checkbox"/> Yes      <input type="checkbox"/> No</p> <p>FOR DAILY WALKS</p>
<p>11. Did you ever seek or get permission to use the route?</p> <p>If 'Yes', from whom?</p>	<p><input type="checkbox"/> Yes      <input checked="" type="checkbox"/> No</p>
<p>12. Have you, or to your knowledge has anyone ever been stopped or turned back?</p> <p>If 'Yes', when and by whom?</p>	<p><input type="checkbox"/> Yes      <input checked="" type="checkbox"/> No</p>
<p>13. Were you ever told by any owner or occupier or by their employee that the route was not public?</p> <p>If 'Yes', when and by whom?</p>	<p><input type="checkbox"/> Yes      <input checked="" type="checkbox"/> No</p>
<p>14. Has your use of the route ever been in the exercise of some private right, such as visiting someone who lived along the route, going to your own land or property, or delivering goods?</p> <p>If 'Yes', please give details?</p>	<p><input checked="" type="checkbox"/> Yes      <input type="checkbox"/> No</p> <p>VISITING FRIENDS AT NEIGHBOURING VILLAGE</p>
<p>15. Is there any documentary evidence to support your claim, eg Inclosure Awards, Tithe Maps, Railway Maps, etc?</p> <p>If 'Yes', please give details?</p>	<p><input type="checkbox"/> Yes      <input type="checkbox"/> No</p> <p>DONT KNOW</p>

For Office Use Only

No:

16. (a) Is the route or any part of it enclosed between boundaries, ie hedges, fences, ditches, walls?

Yes

No

If 'Yes', please give details, including maximum/minimum widths?

HEDGES  
ALONGSIDE PATH.

(b) Is the whole of the width between boundaries used by the public?

Yes

No

If 'No', how much is used?

17. Is there any other information, not given above, which you think will support your claim? (For example, further details of your use of the route as outlined in section 3.) (Continue on a separate sheet if necessary.)

THE WALKWAY IS A SAFE PATH FOR CHILDREN AWAY FROM TRAFFIC ALSO PEOPLE WALKING THEIR PETS FOR EXERCISE, ALSO HELPS TO PREVENTS FOULING OF PATHS ON PUBLIC HIGHWAY



For Office Use Only  
No:

Making a difference where you live

WILDLIFE AND COUNTRYSIDE ACT 1981 - SECTION 53(3)

PUBLIC RIGHT OF WAY EVIDENCE FORM

The object of this enquiry is simply to reach the truth of the matter, whatever it may be. Witnesses are therefore asked to answer the questions as fully as possible and not to keep back any information, whether for or against the public claim. This is of particular importance if the information is to be of real value in establishing the status of the way.

Name: [Redacted] Occupation: RETIRED  
Address: [Redacted] Day Tel No: [Redacted]  
TRIMDON STATION Date of Birth: 31/8/54  
Path runs from: HOLLIER TERR Grid Ref: .....  
to: TRIMDON COLLIERY Grid Ref: .....  
in the Parish of TRIMDON STATION  
and is shown on the map attached to this claim (minimum scale 1:25000).

Please tick (✓) the appropriate boxes

- a) If this claim is contested are you prepared to give evidence at the Local Public Inquiry which might result?  
Yes  No   
If 'No', are you prepared to make a statutory declaration on oath as to the truth of the above information?  
Yes  No

I understand that the information I have given will become public if this dispute is considered by the County Council's Highways Committee.

Signed (on completion of form):  
[Redacted] (Mr/Mrs/Miss/Ms)

Date: 5/7/02

Person completing this form if different from claimant

Name: .....

Please complete this form, attaching a map or plan of the route concerned to:

Access and Rights of Way Section, Environment, Durham County Council,  
County Hall, Durham, DH1 5UQ  
(tel: 0191 383 3452)

For Office Use Only  
No:

Please tick (✓) the appropriate boxes  
Please answer all the questions as fully as possible

1. Why do you regard this way as public?

*It has been a way of way  
for as long as I remember*

2. (a) Have you used it?

	Yes	No	Years during which you have used path							
			*From	To	From	To	From	To		
(i) On Foot?	<input checked="" type="checkbox"/>	<input type="checkbox"/>	<i>1960</i>	<i>until fenced off</i>						
(ii) On Horseback?	<input type="checkbox"/>	<input type="checkbox"/>								
(iii) With a Vehicle?	<input type="checkbox"/>	<input type="checkbox"/>								

(b) On average how many times each year? .....

\*These boxes are provided to allow you to indicate any variations in use which may have occurred over the years.

(c) Where were you going?

From: *Deaf Hill*  
To: *Hinsden Colliery*

(d) For what purpose?

*Shopping, Doctor Surgery, Visiting Barn etc*

3. Have you seen other people using the same route?  Yes  No

If 'Yes' were they:

	Yes	No		Yes	No
(i) Local?	<input checked="" type="checkbox"/>	<input type="checkbox"/>	(iv) On Foot?	<input checked="" type="checkbox"/>	<input type="checkbox"/>
(ii) Strangers?	<input type="checkbox"/>	<input type="checkbox"/>	(v) On Horseback?	<input type="checkbox"/>	<input type="checkbox"/>
(iii) Both?	<input checked="" type="checkbox"/>	<input type="checkbox"/>	(vi) With a Vehicle?	<input type="checkbox"/>	<input type="checkbox"/>

4. Have you always followed the same route:  Yes  No

If 'No' when was it changed? Year: .....

And by whom? .....

5. On the route have there ever been:	Are they still there?	
	Yes	No
Gates?	<input checked="" type="checkbox"/>	<input checked="" type="checkbox"/>
Stiles?	<input type="checkbox"/>	<input type="checkbox"/>

If 'Yes', please mark the locations on the plan.

<p>6. <b>Have there ever been any notices along the route?</b> If 'Yes', what did they say? .....</p> <p>.....</p> <p>Are they still there? If 'Yes', please mark the locations on the plan.</p>	<p><input type="checkbox"/> Yes      <input checked="" type="checkbox"/> No</p> <p><input type="checkbox"/> Yes      <input type="checkbox"/> No</p>
<p>7. <b>Have there ever been any obstructions such as hedges or fences across the route?</b></p> <p>If 'Yes', are they still there? If 'Yes', please mark the locations on the plan.</p>	<p><input type="checkbox"/> Yes      <input checked="" type="checkbox"/> No</p> <p><input type="checkbox"/> Yes      <input type="checkbox"/> No</p>
<p>8. <b>Has any part of the route ever been ploughed or cultivated?</b></p> <p>If 'Yes', please give details and mark on the location plan.</p>	<p><input type="checkbox"/> Yes      <input checked="" type="checkbox"/> No</p>
<p>9. <b>At any time when you used the route were you working for any owner or occupier of any land over which it runs or were you the tenant of any such owner or occupier?</b></p> <p>If 'Yes', please give the dates, and particulars of the owner or occupier.</p> <p>Were you ever told by him whether he regarded the route as a Public Right of Way?</p> <p>If 'Yes', please give details.</p>	<p><input type="checkbox"/> Yes      <input checked="" type="checkbox"/> No</p> <p><input type="checkbox"/> Yes      <input type="checkbox"/> No</p>



For Office Use Only

No:

<p>10. If you answered 'Yes' to the previous question, have you ever used the route during a period when you were NOT an employee or tenant of the owner/occupier?</p> <p>If 'Yes', please give details.</p>	<p><input type="checkbox"/> Yes <input type="checkbox"/> No</p>
<p>11. Did you ever seek or get permission to use the route?</p> <p>If 'Yes', from whom?</p>	<p><input type="checkbox"/> Yes <input checked="" type="checkbox"/> No</p>
<p>12. Have you, or to your knowledge has anyone ever been stopped or turned back?</p> <p>If 'Yes', when and by whom?</p>	<p><input type="checkbox"/> Yes <input checked="" type="checkbox"/> No</p>
<p>13. Were you ever told by any owner or occupier or by their employee that the route was not public?</p> <p>If 'Yes', when and by whom?</p> <p><i>as Question 2</i></p>	<p><input type="checkbox"/> Yes <input checked="" type="checkbox"/> No</p>
<p>14. Has your use of the route ever been in the exercise of some private right, such as visiting someone who lived along the route, going to your own land or property, or delivering goods?</p> <p>If 'Yes', please give details?</p> <p><i>used this route to visit Mother, Brother also to do my shopping and Doctors Surgery</i></p>	<p><input type="checkbox"/> Yes <input type="checkbox"/> No</p>
<p>15. Is there any documentary evidence to support your claim, eg Inclosure Awards, Tithe Maps, Railway Maps, etc?</p> <p>If 'Yes', please give details?</p>	<p><input type="checkbox"/> Yes <input checked="" type="checkbox"/> No</p>

For Office Use Only

No:

16. (a) Is the route or any part of it enclosed between boundaries, ie hedges, fences, ditches, walls?  If 'Yes', please give details, including maximum/minimum widths?	<input checked="" type="checkbox"/> Yes	<input checked="" type="checkbox"/> No
(b) Is the whole of the width between boundaries used by the public?  If 'No', how much is used?	<input checked="" type="checkbox"/> Yes	<input type="checkbox"/> No

17. Is there any other information, not given above, which you think will support your claim? (For example, further details of your use of the route as outlined in section 3.) (Continue on a separate sheet if necessary.)

I have used this route all my life at no time have I been stopped from doing so I have used a number of times a week for visiting family and doing day shopping and to catch buses

I don't see why people should be able to fence off land in this manner and what would it be like if we all did it

Yours Sincerely

Mrs E Carter

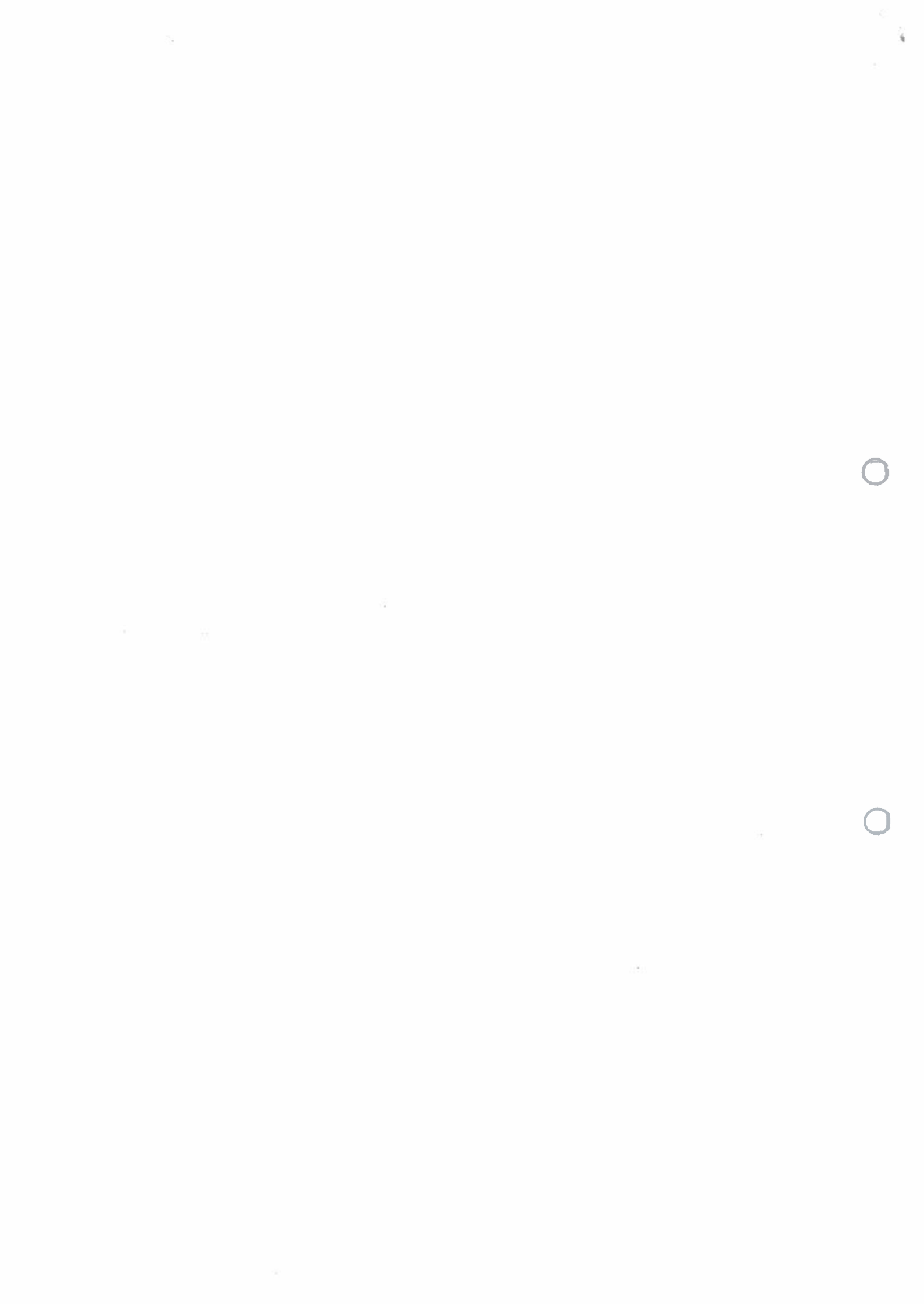



For Office Use Only

No:

Making a difference where you live

WILDLIFE AND COUNTRYSIDE ACT 1981 - SECTION 53(3)

PUBLIC RIGHT OF WAY EVIDENCE FORM

The object of this enquiry is simply to reach the truth of the matter, whatever it may be. Witnesses are therefore asked to answer the questions as fully as possible and not to keep back any information, whether for or against the public claim. This is of particular importance if the information is to be of real value in establishing the status of the way.

Name: [Redacted] Occupation: Retired
Address: [Redacted] Day Tel No: [Redacted]
Trimdon Station Date of Birth: 16-2-45
Path runs from: End of Street Grid Ref:
to: Shops at Trimdon Colliery Grid Ref:
in the Parish of Trimdon Station

and is shown on the map attached to this claim (minimum scale 1:25000).

Please tick (✓) the appropriate boxes

- a) If this claim is contested are you prepared to give evidence at the Local Public Inquiry which might result?
Yes No
[checked] [ ]
If 'No', are you prepared to make a statutory declaration on oath as to the truth of the above information?
Yes No
[ ] [ ]

I understand that the information I have given will become public if this dispute is considered by the County Council's Highways Committee.

Signed (on completion of form):

[Redacted Signature] (Mr/Mrs/Miss/Ms)

Date: 1-4-08

Person completing this form if different from claimant

Name:

Please complete this form, attaching a map or plan of the route concerned to:

Access and Rights of Way Section, Environment, Durham County Council, County Hall, Durham, DH1 5UQ (tel: 0191 383 3452)

For Office Use Only

No:

Please tick (✓) the appropriate boxes  
Please answer all the questions as fully as possible

1. Why do you regard this way as public?

Allway used path as a public way  
to the local shops.

2. (a) Have you used it?

	Yes ✓	No ✓	Years during which you have used path					
			*From	To	From	To	From	To
(i) On Foot?	<input checked="" type="checkbox"/>	<input type="checkbox"/>	1967	until fenced off				
(ii) On Horseback?	<input type="checkbox"/>	<input type="checkbox"/>						
(iii) With a Vehicle?	<input type="checkbox"/>	<input type="checkbox"/>						

(b) On average how many times each year?

200.....

\*These boxes are provided to allow you to indicate any variations in use which may have occurred over the years.

(c) Where were you going?

From: Holmelea Terrace

To: Teindon Coll.

(d) For what purpose?

Shopping, visit friends, Doctors allotment.

3. Have you seen other people using the same route?

Yes

No

If 'Yes' were they:

	Yes ✓	No ✓		Yes ✓	No ✓
(i) Local?	<input checked="" type="checkbox"/>	<input type="checkbox"/>	(iv) On Foot?	<input checked="" type="checkbox"/>	<input type="checkbox"/>
(ii) Strangers?	<input checked="" type="checkbox"/>	<input type="checkbox"/>	(v) On Horseback?	<input type="checkbox"/>	<input checked="" type="checkbox"/>
(iii) Both?	<input checked="" type="checkbox"/>	<input type="checkbox"/>	(vi) With a Vehicle?	<input type="checkbox"/>	<input checked="" type="checkbox"/>

4. Have you always followed the same route:

Yes

No

If 'No' when was it changed?

Year: .....

And by whom? .....

For Office Use Only  
No:

<b>5. On the route have there ever been:</b>	<b>Are they still there?</b>			
	Yes	No	Yes	No
	✓	✓	✓	✓
Gates?	<input type="checkbox"/>	<input checked="" type="checkbox"/>	<input type="checkbox"/>	<input type="checkbox"/>
Stiles?	<input type="checkbox"/>	<input checked="" type="checkbox"/>	<input type="checkbox"/>	<input type="checkbox"/>

If 'Yes', please mark the locations on the plan.

<p><b>6. Have there ever been any notices along the route?</b> If 'Yes', what did they say? .....</p> <p>.....</p> <p>Are they still there? If 'Yes', please mark the locations on the plan.</p>	<input type="checkbox"/> Yes	<input checked="" type="checkbox"/> No
<p><b>7. Have there ever been any obstructions such as hedges or fences across the route?</b></p> <p>If 'Yes', are they still there? If 'Yes', please mark the locations on the plan.</p>	<input type="checkbox"/> Yes  <input type="checkbox"/> Yes	<input checked="" type="checkbox"/> No  <input type="checkbox"/> No
<p><b>8. Has any part of the route ever been ploughed or cultivated?</b></p> <p>If 'Yes', please give details and mark on the location plan.</p>	<input type="checkbox"/> Yes	<input checked="" type="checkbox"/> No
<p><b>9. At any time when you used the route were you working for any owner or occupier of any land over which it runs or were you the tenant of any such owner or occupier?</b></p> <p>If 'Yes', please give the dates, and particulars of the owner or occupier.</p> <p>Were you ever told by him whether he regarded the route as a Public Right of Way?</p> <p>If 'Yes', please give details.</p>	<input type="checkbox"/> Yes   <input type="checkbox"/> Yes	<input checked="" type="checkbox"/> No   <input type="checkbox"/> No

For Office Use Only

No:

<p><b>10. If you answered 'Yes' to the previous question, have you ever used the route during a period when you were NOT an employee or tenant of the owner/occupier?</b></p> <p>If 'Yes', please give details.</p>	<p><input type="checkbox"/> Yes      <input type="checkbox"/> No</p>
<p><b>11. Did you ever seek or get permission to use the route?</b></p> <p>If 'Yes', from whom?</p>	<p><input type="checkbox"/> Yes      <input checked="" type="checkbox"/> No</p>
<p><b>12. Have you, or to your knowledge has anyone ever been stopped or turned back?</b></p> <p>If 'Yes', when and by whom?</p>	<p><input type="checkbox"/> Yes      <input checked="" type="checkbox"/> No</p>
<p><b>13. Were you ever told by any owner or occupier or by their employee that the route was not public?</b></p> <p>If 'Yes', when and by whom?</p>	<p><input type="checkbox"/> Yes      <input checked="" type="checkbox"/> No</p>
<p><b>14. Has your use of the route ever been in the exercise of some private right, such as visiting someone who lived along the route, going to your own land or property, or delivering goods?</b></p> <p>If 'Yes', please give details?</p>	<p><input checked="" type="checkbox"/> Yes      <input checked="" type="checkbox"/> No</p>
<p><b>15. Is there any documentary evidence to support your claim, eg Inclosure Awards, Tithe Maps, Railway Maps, etc?</b></p> <p>If 'Yes', please give details?</p>	<p><input type="checkbox"/> Yes      <input checked="" type="checkbox"/> No</p>

For Office Use Only

No:

<p>16. (a) Is the route or any part of it enclosed between boundaries, ie hedges, fences, ditches, walls?</p> <p>If 'Yes', please give details, including maximum/minimum widths?</p>	<p><input type="checkbox"/> Yes      <input checked="" type="checkbox"/> No</p> <p>15' now.</p>
<p>(b) Is the whole of the width between boundaries used by the public?</p> <p>If 'No', how much is used?</p>	<p><input type="checkbox"/> Yes      <input type="checkbox"/> No</p> <p>?</p>

17. Is there any other information, not given above, which you think will support your claim? (For example, further details of your use of the route as outlined in section 3.) (Continue on a separate sheet if necessary.)

Mother in law (recently died) said she always used path as a child, she was born in 1910. She lived a no. 4. Holmelea Terrace.



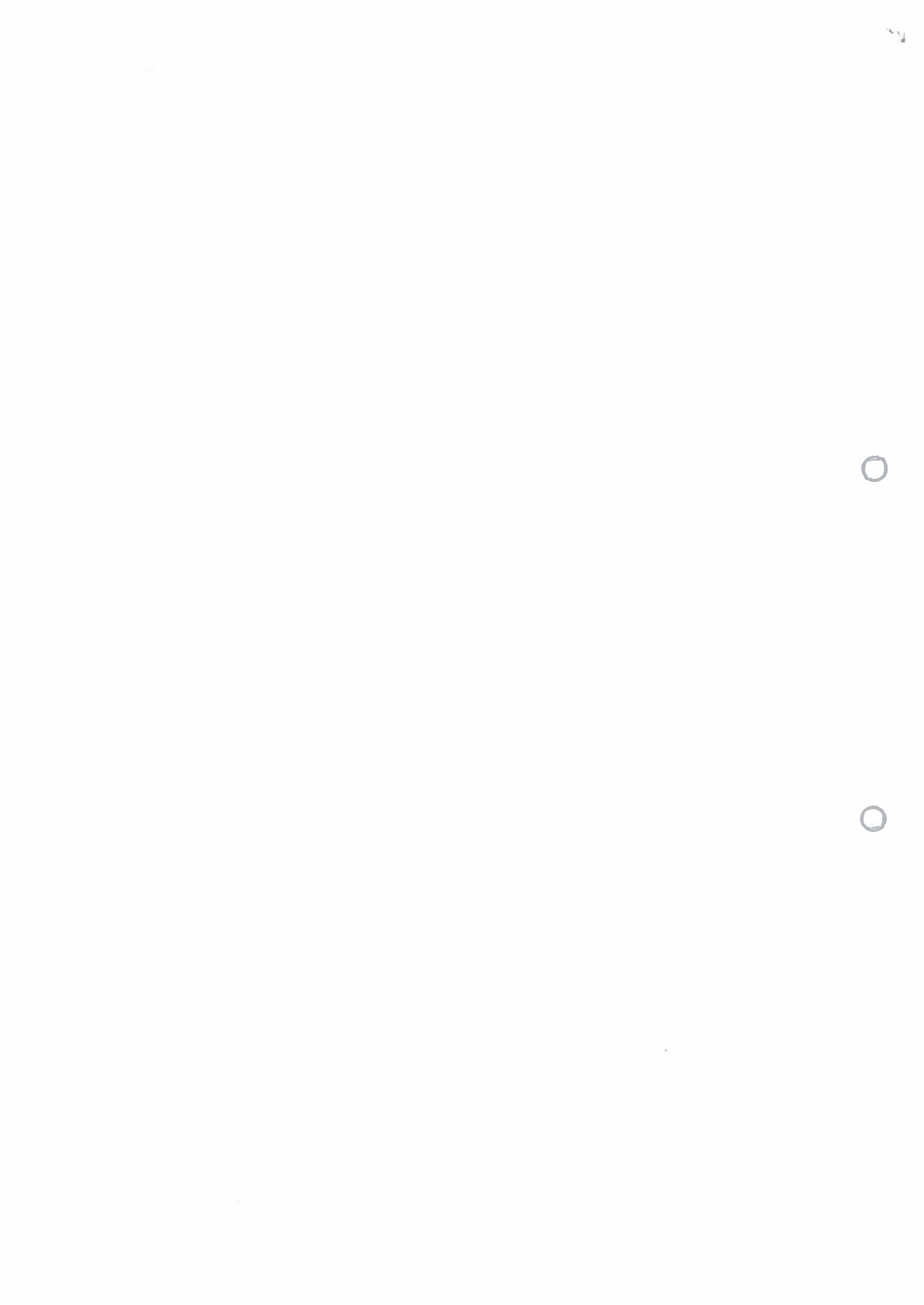



For Office Use Only

No:

Making a difference where you live

WILDLIFE AND COUNTRYSIDE ACT 1981 - SECTION 53(3)

PUBLIC RIGHT OF WAY EVIDENCE FORM

The object of this enquiry is simply to reach the truth of the matter, whatever it may be. Witnesses are therefore asked to answer the questions as fully as possible and not to keep back any information, whether for or against the public claim. This is of particular importance if the information is to be of real value in establishing the status of the way.

Name: [Redacted] Occupation: RETIRED
Address: [Redacted] Day Tel No: [Redacted]
TRIMDON STATION Co. DURHAM Date of Birth: 3.3.1929
Path runs from: to: in the Parish of TRIMDON FOUNDRY PARISH COUNCIL
and is shown on the map attached to this claim (minimum scale 1:25000).

Please tick (✓) the appropriate boxes

- a) If this claim is contested are you prepared to give evidence at the Local Public Inquiry which might result?
Yes [checked] No [ ]
If 'No', are you prepared to make a statutory declaration on oath as to the truth of the above information?
Yes [ ] No [ ]

I understand that the information I have given will become public if this dispute is considered by the County Council's Highways Committee.

Signed (on completion of form): [Redacted Signature] (Mr/Mrs/Miss/Ms)

Date: 12.7.2008

Person completing this form if different from claimant
Name:

Please complete this form, attaching a map or plan of the route concerned to:
Access and Rights of Way Section, Environment, Durham County Council,
County Hall, Durham, DH1 5UQ
(tel: 0191 383 3452)

For Office Use Only

No:

Please tick (✓) the appropriate boxes  
Please answer all the questions as fully as possible

1. Why do you regard this way as public?

.....  
.....  
.....

2. (a) Have you used it?

	Yes	No	Years during which you have used path						
			*From	To	From	To	From	To	
(i) On Foot?	<input checked="" type="checkbox"/>	<input type="checkbox"/>							
(ii) On Horseback?	<input type="checkbox"/>	<input type="checkbox"/>							
(iii) With a Vehicle?	<input type="checkbox"/>	<input type="checkbox"/>							

(b) On average how many times each year?

300

\*These boxes are provided to allow you to indicate any variations in use which may have occurred over the years.

(c) Where were you going?

From: TRIMDON STATION  
To: TRIMDON CORNER

(d) For what purpose?

SHOPPING

3. Have you seen other people using the same route?

Yes

No

If 'Yes' were they:

	Yes	No		Yes	No
(i) Local?	<input checked="" type="checkbox"/>	<input type="checkbox"/>	(iv) On Foot?	<input checked="" type="checkbox"/>	<input type="checkbox"/>
(ii) Strangers?	<input type="checkbox"/>	<input type="checkbox"/>	(v) On Horseback?	<input type="checkbox"/>	<input type="checkbox"/>
(iii) Both?	<input checked="" type="checkbox"/>	<input type="checkbox"/>	(vi) With a Vehicle?	<input type="checkbox"/>	<input type="checkbox"/>

4. Have you always followed the same route:

Yes

No

If 'No' when was it changed?

Year: .....

And by whom? .....

5. On the route have there ever been:	Are they still there?	
	Yes	No
Gates?	<input checked="" type="checkbox"/>	<input checked="" type="checkbox"/>
Stiles?	<input type="checkbox"/>	<input type="checkbox"/>

If 'Yes', please mark the locations on the plan.

<p>6. Have there ever been any notices along the route? If 'Yes', what did they say? .....</p> <p>.....</p> <p>Are they still there? If 'Yes', please mark the locations on the plan.</p>	<p><input type="checkbox"/> Yes      <input checked="" type="checkbox"/> No</p> <p><input type="checkbox"/> Yes      <input type="checkbox"/> No</p>
<p>7. Have there ever been any obstructions such as hedges or fences across the route?</p> <p>If 'Yes', are they still there? If 'Yes', please mark the locations on the plan.</p>	<p><input checked="" type="checkbox"/> Yes      <input type="checkbox"/> No</p> <p><input checked="" type="checkbox"/> Yes      <input type="checkbox"/> No</p>
<p>8. Has any part of the route ever been ploughed or cultivated?</p> <p>If 'Yes', please give details and mark on the location plan.</p>	<p><input type="checkbox"/> Yes      <input checked="" type="checkbox"/> No</p>
<p>9. At any time when you used the route were you working for any owner or occupier of any land over which it runs or were you the tenant of any such owner or occupier?</p> <p>If 'Yes', please give the dates, and particulars of the owner or occupier.</p> <p>Were you ever told by him whether he regarded the route as a Public Right of Way?</p> <p>If 'Yes', please give details.</p>	<p><input type="checkbox"/> Yes      <input checked="" type="checkbox"/> No</p> <p><input type="checkbox"/> Yes      <input type="checkbox"/> No</p>

For Office Use Only

No:

<p><b>10. If you answered 'Yes' to the previous question, have you ever used the route during a period when you were NOT an employee or tenant of the owner/occupier?</b></p> <p>If 'Yes', please give details.</p>	<p><input type="checkbox"/> Yes      <input type="checkbox"/> No</p>
<p><b>11. Did you ever seek or get permission to use the route?</b></p> <p>If 'Yes', from whom?</p>	<p><input type="checkbox"/> Yes      <input type="checkbox"/> No</p>
<p><b>12. Have you, or to your knowledge has anyone ever been stopped or turned back?</b></p> <p>If 'Yes', when and by whom?</p>	<p><input type="checkbox"/> Yes      <input type="checkbox"/> No</p>
<p><b>13. Were you ever told by any owner or occupier or by their employee that the route was not public?</b></p> <p>If 'Yes', when and by whom?</p>	<p><input type="checkbox"/> Yes      <input type="checkbox"/> No</p>
<p><b>14. Has your use of the route ever been in the exercise of some private right, such as visiting someone who lived along the route, going to your own land or property, or delivering goods?</b></p> <p>If 'Yes', please give details?</p>	<p><input type="checkbox"/> Yes      <input type="checkbox"/> No</p>
<p><b>15. Is there any documentary evidence to support your claim, eg Inclosure Awards, Tithe Maps, Railway Maps, etc?</b></p> <p>If 'Yes', please give details?</p>	<p><input type="checkbox"/> Yes      <input type="checkbox"/> No</p>

For Office Use Only

No:

16. (a) Is the route or any part of it enclosed between boundaries, ie hedges, fences, ditches, walls?

Yes

No

If 'Yes', please give details, including maximum/minimum widths?

(b) Is the whole of the width between boundaries used by the public?

Yes

No

If 'No', how much is used?

17. Is there any other information, not given above, which you think will support your claim? (For example, further details of your use of the route as outlined in section 3.) (Continue on a separate sheet if necessary.)

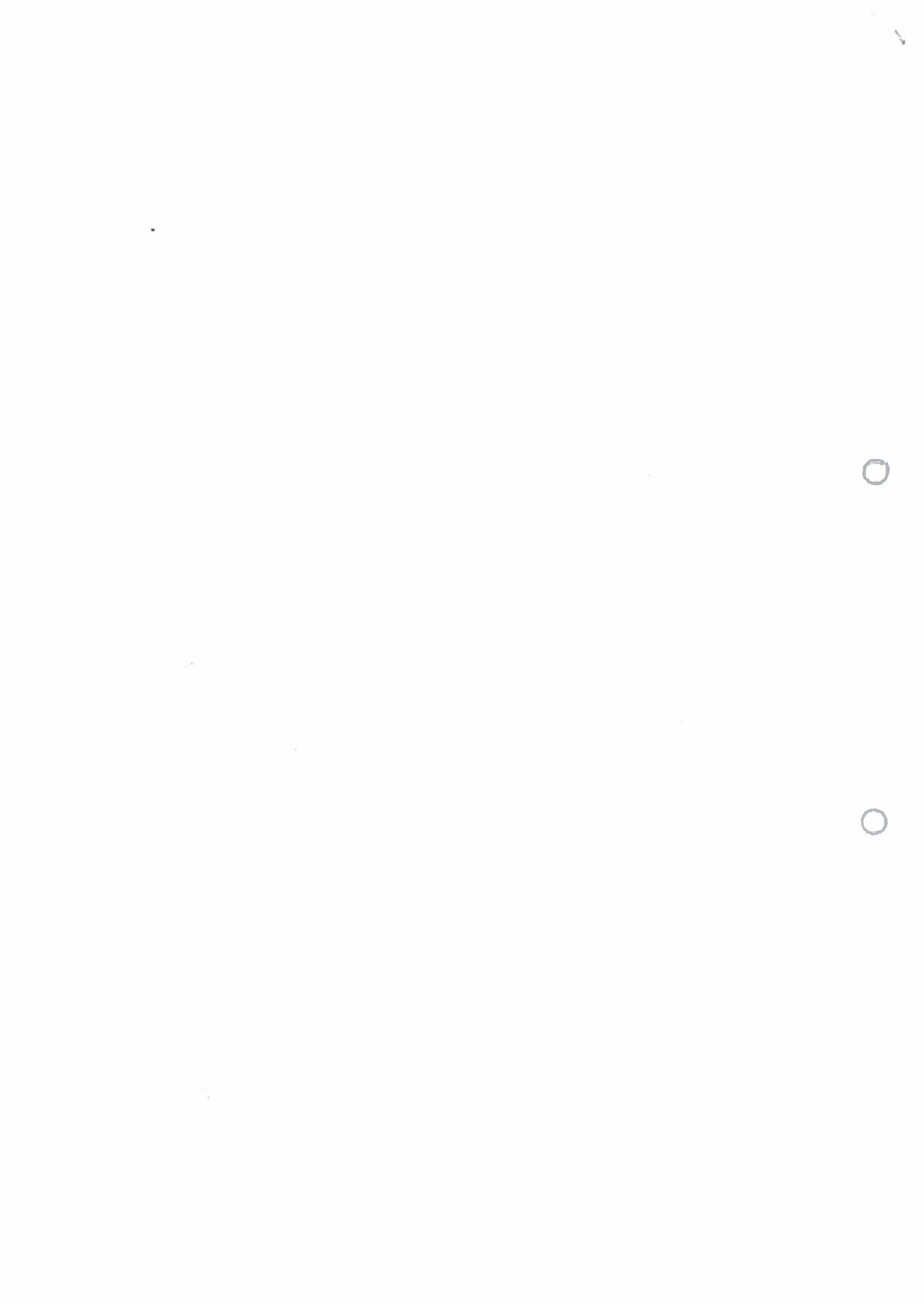



For Office Use Only  
No:

Making a difference where you live

WILDLIFE AND COUNTRYSIDE ACT 1981 - SECTION 53(3)

PUBLIC RIGHT OF WAY EVIDENCE FORM

The object of this enquiry is simply to reach the truth of the matter, whatever it may be. Witnesses are therefore asked to answer the questions as fully as possible and not to keep back any information, whether for or against the public claim. This is of particular importance if the information is to be of real value in establishing the status of the way.

Name: [Redacted] Occupation: RETIRED  
Address: [Redacted] Day Tel No: [Redacted]  
Date of Birth: 30-4-40  
Path runs from: ABOVE TO  
to: TRIMDON LANE  
in the Parish of TRIMDON STATION  
and is shown on the map attached to this claim (minimum scale 1:25000).

Please tick (✓) the appropriate boxes

- a) If this claim is contested are you prepared to give evidence at the Local Public Inquiry which might result?  
Yes [checked] No [ ]  
If 'No', are you prepared to make a statutory declaration on oath as to the truth of the above information?  
Yes [ ] No [ ]

I understand that the information I have given will become public if this dispute is considered by the County Council's Highways Committee.

Signed (on completion of form); [Redacted] (Mr/Mrs/Miss/Ms)

Date: 1/11/08

Person completing this form if different from claimant  
Name:

Please complete this form, attaching a map or plan of the route concerned to:

Access and Rights of Way Section, Environment, Durham County Council,  
County Hall, Durham, DH1 5UQ  
(tel: 0191 383 3452)



For Office Use Only

No:

Please tick (✓) the appropriate boxes  
Please answer all the questions as fully as possible

1. Why do you regard this way as public?

*This Path was always a Public Footpath*

2. (a) Have you used it?

	Yes	No	Years during which you have used path					
			*From	To	From	To	From	To
(i) On Foot?	<input checked="" type="checkbox"/>	<input type="checkbox"/>	<i>1978</i>	<i>2000</i>	<i>1978</i>	<i>1978</i>	<i>1978</i>	<i>2000</i>
(ii) On Horseback?	<input type="checkbox"/>	<input type="checkbox"/>						
(iii) With a Vehicle?	<input type="checkbox"/>	<input type="checkbox"/>						

(b) On average how many times each year?

*200* .....

\*These boxes are provided to allow you to indicate any variations in use which may have occurred over the years.

(c) Where were you going?

From: *North Lea Tce*  
To: *London Rd*

(d) For what purpose?

*Shopping in my town - general shopping  
Doctors*

3. Have you seen other people using the same route?

Yes  No

If 'Yes' were they:

	Yes	No		Yes	No
(i) Local?	<input checked="" type="checkbox"/>	<input type="checkbox"/>	(iv) On Foot?	<input checked="" type="checkbox"/>	<input type="checkbox"/>
(ii) Strangers?	<input type="checkbox"/>	<input type="checkbox"/>	(v) On Horseback?	<input type="checkbox"/>	<input checked="" type="checkbox"/>
(iii) Both?	<input checked="" type="checkbox"/>	<input type="checkbox"/>	(vi) With a Vehicle?	<input type="checkbox"/>	<input checked="" type="checkbox"/>

4. Have you always followed the same route:

Yes  No

If 'No' when was it changed?

Year: *When land was taken off*

And by whom? *Adjacent Property owner*

For Office Use Only

No:

5. On the route have there ever been:	Are they still there?	
	Yes	No
Gates?	<input checked="" type="checkbox"/>	<input checked="" type="checkbox"/>
Stiles?	<input type="checkbox"/>	<input type="checkbox"/>

If 'Yes', please mark the locations on the plan.

<p>6. Have there ever been any notices along the route? If 'Yes', what did they say? .....</p> <p>.....</p> <p>Are they still there? If 'Yes', please mark the locations on the plan.</p>	<p><input type="checkbox"/> Yes <input checked="" type="checkbox"/> No</p> <p><input type="checkbox"/> Yes <input type="checkbox"/> No</p>
<p>7. Have there ever been any obstructions such as hedges or fences across the route?</p> <p>If 'Yes', are they still there? If 'Yes', please mark the locations on the plan.</p>	<p><input type="checkbox"/> Yes <input checked="" type="checkbox"/> No</p> <p><input type="checkbox"/> Yes <input type="checkbox"/> No</p>
<p>8. Has any part of the route ever been ploughed or cultivated?</p> <p>If 'Yes', please give details and mark on the location plan.</p>	<p><input type="checkbox"/> Yes <input checked="" type="checkbox"/> No</p>
<p>9. At any time when you used the route were you working for any owner or occupier of any land over which it runs or were you the tenant of any such owner or occupier?</p> <p>If 'Yes', please give the dates, and particulars of the owner or occupier.</p> <p>Were you ever told by him whether he regarded the route as a Public Right of Way?</p> <p>If 'Yes', please give details.</p>	<p><input type="checkbox"/> Yes <input checked="" type="checkbox"/> No</p> <p><input type="checkbox"/> Yes <input type="checkbox"/> No</p>

For Office Use Only

No:

<p>10. If you answered 'Yes' to the previous question, have you ever used the route during a period when you were NOT an employee or tenant of the owner/occupier?</p> <p>If 'Yes', please give details.</p>	<p><input type="checkbox"/> Yes <input type="checkbox"/> No</p>
<p>11. Did you ever seek or get permission to use the route?</p> <p>If 'Yes', from whom?</p>	<p><input type="checkbox"/> Yes <input checked="" type="checkbox"/> No</p>
<p>12. Have you, or to your knowledge has anyone ever been stopped or turned back?</p> <p>If 'Yes', when and by whom?</p>	<p><input type="checkbox"/> Yes <input checked="" type="checkbox"/> No</p>
<p>13. Were you ever told by any owner or occupier or by their employee that the route was not public?</p> <p>If 'Yes', when and by whom?</p>	<p><input type="checkbox"/> Yes <input checked="" type="checkbox"/> No</p>
<p>14. Has your use of the route ever been in the exercise of some private right, such as visiting someone who lived along the route, going to your own land or property, or delivering goods?</p> <p>If 'Yes', please give details?</p>	<p><input checked="" type="checkbox"/> Yes <input type="checkbox"/> No</p>
<p>15. Is there any documentary evidence to support your claim, eg Inclosure Awards, Tithe Maps, Railway Maps, etc?</p> <p>If 'Yes', please give details?</p>	<p><input type="checkbox"/> Yes <input checked="" type="checkbox"/> No</p>

For Office Use Only

No:

16. (a) Is the route or any part of it enclosed between boundaries, ie hedges, fences, ditches, walls?

Yes

No

If 'Yes', please give details, including maximum/minimum widths?

*NOT IN THE ROUTE*

(b) Is the whole of the width between boundaries used by the public?

Yes

No

If 'No', how much is used?

*?*

17. Is there any other information, not given above, which you think will support your claim? (For example, further details of your use of the route as outlined in section 3.) (Continue on a separate sheet if necessary.)

*I have spoken to a number of people, long term residents who insist that it was always a path, even before the second world war. I am 68 years old and I remember using it as a small boy.*

*W. G. B.*



For Office Use Only  
No:

Making a difference where you live

WILDLIFE AND COUNTRYSIDE ACT 1981 – SECTION 53(3)

PUBLIC RIGHT OF WAY EVIDENCE FORM

The object of this enquiry is simply to reach the truth of the matter, whatever it may be. Witnesses are therefore asked to answer the questions as fully as possible and not to keep back any information, whether for or against the public claim. This is of particular importance if the information is to be of real value in establishing the status of the way.

Name: [Redacted] Occupation: RETIRED  
Address: [Redacted] Day Tel No: [Redacted]  
TRIMDON STATION Co DURHAM Date of Birth: 8.9.1927  
Path runs from: ..... Grid Ref: .....  
to: ..... Grid Ref: .....  
in the Parish of TRIMDON FOONDLY PARISH COUNCIL  
and is shown on the map attached to this claim (minimum scale 1:25000).

Please tick (✓) the appropriate boxes

- a) If this claim is contested are you prepared to give evidence at the Local Public Inquiry which might result?  
Yes  No   
If 'No', are you prepared to make a statutory declaration on oath as to the truth of the above information?  
Yes  No

I understand that the information I have given will become public if this dispute is considered by the County Council's Highways Committee.

Signed (on completion of form): [Redacted] (Mr/Mrs/Miss/Ms)

Date: 12.7.2008

Person completing this form if different from claimant

Name: .....

Please complete this form, attaching a map or plan of the route concerned to:

Access and Rights of Way Section, Environment, Durham County Council,  
County Hall, Durham, DH1 5UQ  
(tel: 0191 383 3452)

For Office Use Only

No:

Please tick (✓) the appropriate boxes  
Please answer all the questions as fully as possible

1. Why do you regard this way as public?

.....  
.....  
.....

2. (a) Have you used it?

	Yes ✓	No ✓	Years during which you have used path					
			From	To	From	To	From	To
(i) On Foot?	<input checked="" type="checkbox"/>	<input type="checkbox"/>						
(ii) On Horseback?	<input type="checkbox"/>	<input type="checkbox"/>						
(iii) With a Vehicle?	<input type="checkbox"/>	<input type="checkbox"/>						

(b) On average how many times each year?

300

\*These boxes are provided to allow you to indicate any variations in use which may have occurred over the years.

(c) Where were you going?

From: TRINDON STATION  
To: TRINDON COLLEGE

(d) For what purpose?

SHOPPING

3. Have you seen other people using the same route?

Yes

No

If 'Yes' were they:

	Yes ✓	No ✓		Yes ✓	No ✓
(i) Local?	<input type="checkbox"/>	<input type="checkbox"/>	(iv) On Foot?	<input checked="" type="checkbox"/>	<input type="checkbox"/>
(ii) Strangers?	<input type="checkbox"/>	<input type="checkbox"/>	(v) On Horseback?	<input type="checkbox"/>	<input type="checkbox"/>
(iii) Both?	<input checked="" type="checkbox"/>	<input type="checkbox"/>	(vi) With a Vehicle?	<input type="checkbox"/>	<input type="checkbox"/>

4. Have you always followed the same route:

Yes

No

If 'No' when was it changed?

Year: .....

And by whom? .....

For Office Use Only

No:

5. On the route have there ever been:	Are they still there?	
	Yes	No
Gates?	<input checked="" type="checkbox"/>	<input checked="" type="checkbox"/>
Stiles?	<input type="checkbox"/>	<input checked="" type="checkbox"/>

If 'Yes', please mark the locations on the plan.

<p>6. <b>Have there ever been any notices along the route?</b> If 'Yes', what did they say? .....</p> <p>.....</p> <p>Are they still there? If 'Yes', please mark the locations on the plan.</p>	<p><input type="checkbox"/> Yes      <input checked="" type="checkbox"/> No</p> <p><input type="checkbox"/> Yes      <input type="checkbox"/> No</p>
<p>7. <b>Have there ever been any obstructions such as hedges or fences across the route?</b></p> <p>If 'Yes', are they still there? If 'Yes', please mark the locations on the plan.</p>	<p><input checked="" type="checkbox"/> Yes      <input type="checkbox"/> No</p> <p><input checked="" type="checkbox"/> Yes      <input type="checkbox"/> No</p>
<p>8. <b>Has any part of the route ever been ploughed or cultivated?</b></p> <p>If 'Yes', please give details and mark on the location plan.</p>	<p><input type="checkbox"/> Yes      <input checked="" type="checkbox"/> No</p>
<p>9. <b>At any time when you used the route were you working for any owner or occupier of any land over which it runs or were you the tenant of any such owner or occupier?</b></p> <p>If 'Yes', please give the dates, and particulars of the owner or occupier.</p> <p>Were you ever told by him whether he regarded the route as a Public Right of Way?</p> <p>If 'Yes', please give details.</p>	<p><input type="checkbox"/> Yes      <input checked="" type="checkbox"/> No</p> <p><input type="checkbox"/> Yes      <input type="checkbox"/> No</p>

For Office Use Only

No:

<p><b>10. If you answered 'Yes' to the previous question, have you ever used the route during a period when you were NOT an employee or tenant of the owner/occupier?</b></p> <p>If 'Yes', please give details.</p>	<p><input type="checkbox"/> Yes      <input type="checkbox"/> No</p>
<p><b>11. Did you ever seek or get permission to use the route?</b></p> <p>If 'Yes', from whom?</p>	<p><input type="checkbox"/> Yes      <input type="checkbox"/> No</p>
<p><b>12. Have you, or to your knowledge has anyone ever been stopped or turned back?</b></p> <p>If 'Yes', when and by whom?</p>	<p><input type="checkbox"/> Yes      <input type="checkbox"/> No</p>
<p><b>13. Were you ever told by any owner or occupier or by their employee that the route was not public?</b></p> <p>If 'Yes', when and by whom?</p>	<p><input type="checkbox"/> Yes      <input type="checkbox"/> No</p>
<p><b>14. Has your use of the route ever been in the exercise of some private right, such as visiting someone who lived along the route, going to your own land or property, or delivering goods?</b></p> <p>If 'Yes', please give details?</p>	<p><input type="checkbox"/> Yes      <input type="checkbox"/> No</p>
<p><b>15. Is there any documentary evidence to support your claim, eg Inclosure Awards, Tithe Maps, Railway Maps, etc?</b></p> <p>If 'Yes', please give details?</p>	<p><input type="checkbox"/> Yes      <input type="checkbox"/> No</p>



For Office Use Only

No:

16. (a) Is the route or any part of it enclosed between boundaries, ie hedges, fences, ditches, walls?  Yes  No

If 'Yes', please give details, including maximum/minimum widths?

(b) Is the whole of the width between boundaries used by the public?  Yes  No

If 'No', how much is used?

17. Is there any other information, not given above, which you think will support your claim? (For example, further details of your use of the route as outlined in section 3.) (Continue on a separate sheet if necessary.)

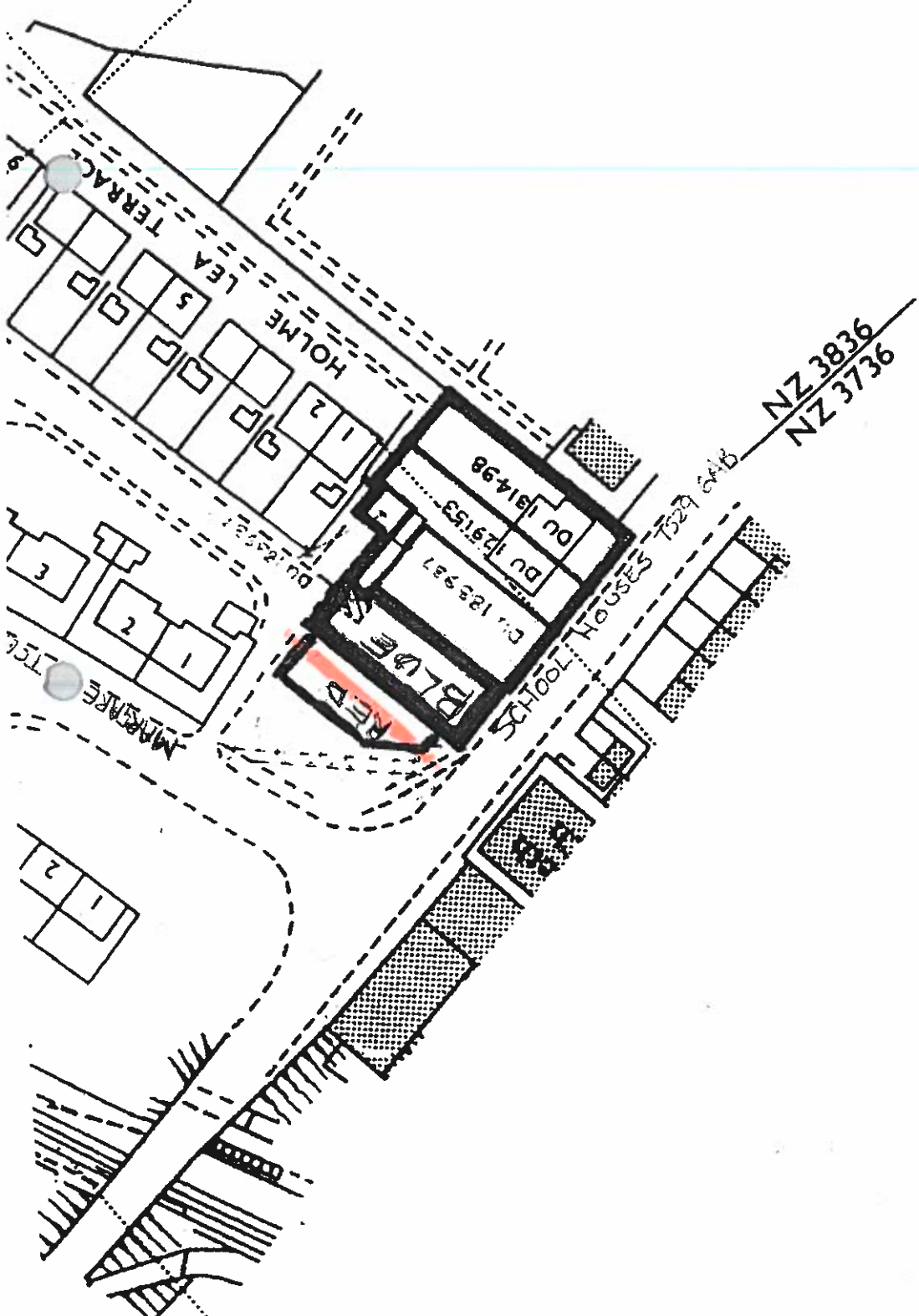

k